

SITE PLAN
NTS

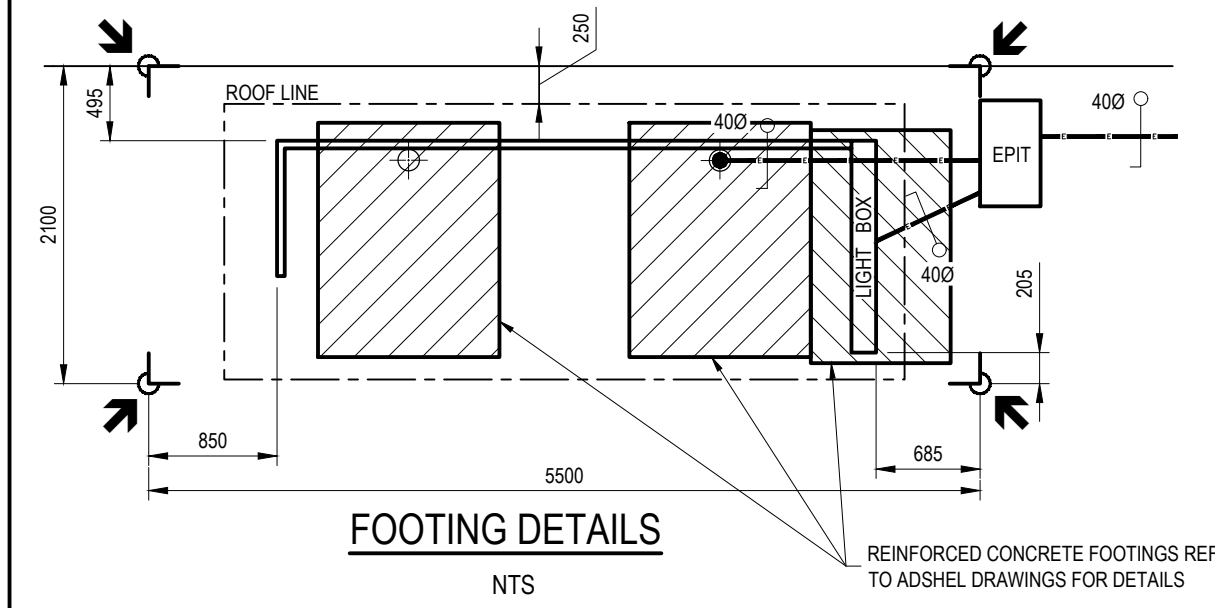

FOOTING DETAILS
NTS

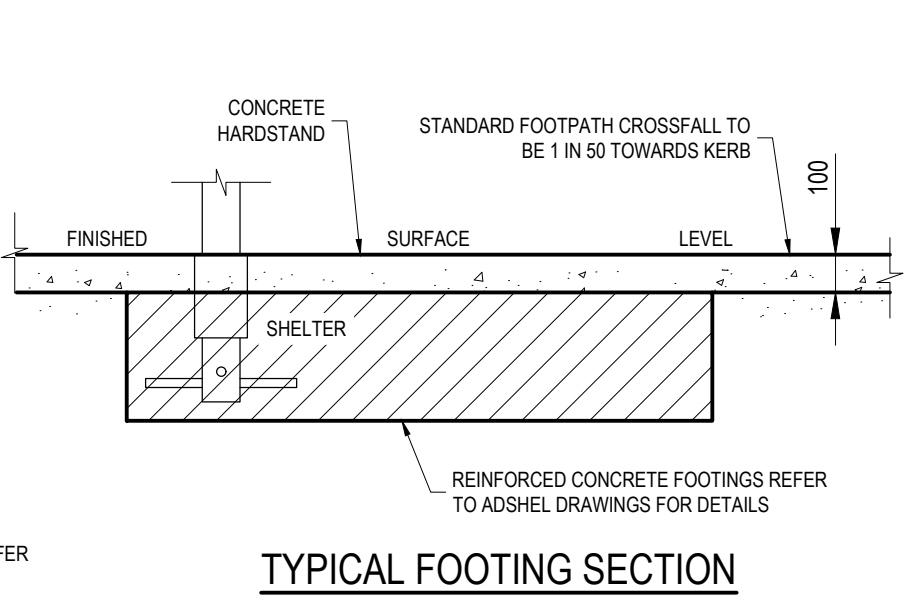

TYPICAL FOOTING SECTION
NTS

NOTES:

1. TO BE READ IN CONJUNCTION WITH ADSHEL DRAWINGS. ADSHEL SHELTERS ARE INSTALLED AND MAINTAINED BY ADSHEL UNDER A CONTRACT TO COUNCIL.
2. WHERE BUS STOP BOARDING SLAB HAS A CROSSFALL GREATER THAN 1 in 40 (IN BOTH DIRECTIONS) OR VERGE IS LESS THAN MINIMUM WIDTH SHOWN, REFER TO BRISBANE CITY COUNCIL PUBLIC TRANSPORT FACILITIES FOR DDA COMPLIANCE ADVICE.
3. MINIMUM CLEAR ACCESS OF 1.2m REQUIRED BETWEEN ALL INFRASTRUCTURE PAST ALLOCATED WHEELCHAIR SPACES.
4. POWER SUPPLY MUST BE RATE 2. LIGHT BOX POWER SUPPLY MUST BE RATE 2 UNMETERED (TARIFF 21).
5. 600 MIN. COVER TO CONDUITS.
6. HARDSTANDS TO BE 150mm THICK BROOM FINISHED (FOR SLIP RESISTANCE) GRADE N32 CONCRETE. SL82 MESH PLACED CENTRALLY. LEVELS TO BE CONFIRMED PRIOR TO CONCRETE POUR.
7. ALTERNATIVE SURFACE FINISHES (i.e. EXPOSED AGGREGATE OR PAVERS) TO COMPLY WITH DISABILITY STANDARD FOR LUMINANCE CONTRAST AND/OR AESTHETICS FOR 'CITY SIGNATURE' REQUIREMENTS, AS REQUIRED.
8. THE ALIGNMENT AND DEPTHS OF EXISTING SERVICES SHALL BE PROVEN ON SITE PRIOR TO ANY EXCAVATION. CONTACT "DIAL BEFORE YOU DIG" ON TEL. NO. 1100 FOR THE LOCATION OF SERVICE AUTHORITY ASSETS.
9. POINT OF SUPPLY PRIORITY:
 1. EP/ELP (ELECTRICITY POWER/LIGHT POLE)
 2. EPIL (ELECTRICITY PILLAR)
 3. EPIT (ELECTRICITY No.4 PIT)
 4. LP (STREET LIGHT POLE)
10. WHERE PLANTINGS ARE PROVIDED, USE ONLY GROUND COVER OR LOW SHRUBS (<0.5m HIGH). TREES FOR SHADE SHOULD BE LONG-TRUNKED WITH MINIMUM BRANCH HEIGHT OF 4.5m. PLANTINGS SHOULD NOT OBSTRUCT LINE OF SIGHT BETWEEN APPROACHING VEHICLES AND LIGHT BOX DISPLAY. (PUBLIC TRANSPORT FACILITIES TO APPROVE LAYOUT).
11. TGSi COLOURS AND INSTALLATION TO BSD-5218.
12. TGSi TO EXTEND TO EDGE OF PATH OR REAL PROPERTY BOUNDARY (FULL WIDTH PATH).
13. WHOLE TGSi TO BE PLACED AT END OF PAD. TGSi'S TO BE CUT TO ENSURE THAT NO TGSi IS LESS THAN 150mm LONG.
14. STORMWATER SOLUTION/DESIGN TO BE ASSESSED ON A SITE-BY-SITE BASIS.
15. LONGITUDINAL GRADE TO MATCH ROAD.
16. REFER INFRASTRUCTURE DESIGN PLANNING SCHEME POLICY FOR LAYOUT AND ON-ROAD REQUIREMENTS.
17. ALL DIMENSIONS ARE IN MILLIMETERS (U.N.O.).

LEGEND

- SETOUT POINTS (INCLUDING FINISHED SURFACE LEVELS) TO BE MARKED ON SITE FOR ADSHEL TO CONSTRUCT FOOTINGS
- 040 uPVC ORANGE (HD) CONDUIT WITH CABLE PROTECTION COVER STRIP
- HAZARD TACTILE GROUND SURFACE INDICATORS AS PER AS1428.4.1 (SEE NOTE 11)
- DIRECTIONAL TACTILE GROUND SURFACE INDICATORS AS PER AS1428.4.1 (SEE NOTE 11)
- EXPANSION JOINT (REFER TO BSD-5202 FOR DETAILS)
- ALLOCATED WHEELCHAIR SPACE (1300x800)
- NOMINAL FACE OF KERB

| ISSUE | AMENDMENT | DRAWN DATE | CHK'D DATE | APPR'D DATE |
|-------|--|------------|------------|-------------|
| B | Dimensions Corrected, Notes 11 to 16 Added | OCT '17 | JUL '18 | NOV '18 |
| A | Drawing Converted from UMS Series April 2014 | APR '14 | APR '14 | APR '14 |

DRAWING AUTHORISED FOR PUBLICATION
 P.COTTON SIGNATURE ON ORIGINAL
 DATED 21/03/06 R.P.E.O: 2 5 4 6
 ASSET ENGINEERING MANAGER
 STRATEGIC ASSET MANAGEMENT

DESIGN APPROVED
 B.HANSON SIGNATURE ON ORIGINAL
 DATED 13/03/06
 PRINCIPAL ENGINEER
 STRATEGIC INFRASTRUCTURE MANGEMENT

| | | | |
|------------------|--|------|---------|
| DESIGN | DBS [City Design] | DATE | May '04 |
| DRAWN | MAB [City Design] | DATE | May '04 |
| CHECKED | DJL [City Assests] | DATE | Nov '05 |
| DRAWING FILENAME | BSD-2107 (B) Adshel 'Mini' bus shelter | | |
| ASSOCIATED PLANS | SUPERSEDES UMS-275 | | |

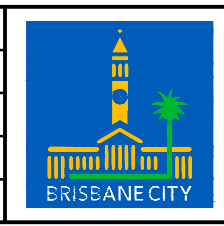

BRISBANE CITY COUNCIL STANDARD DRAWING

SCALE: NOT TO SCALE

DWG No. **BSD-2107**

ADSHEL 'MINI' BUS SHELTER

| | |
|---------------|----------|
| ORIGINAL SIZE | REVISION |
| A3 | B |