

TYPICAL DETAIL

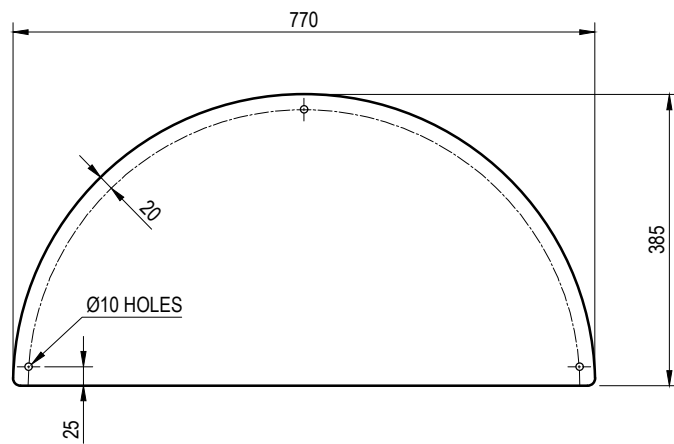

**GRAPHIC PANEL
SIZE DETAILS**

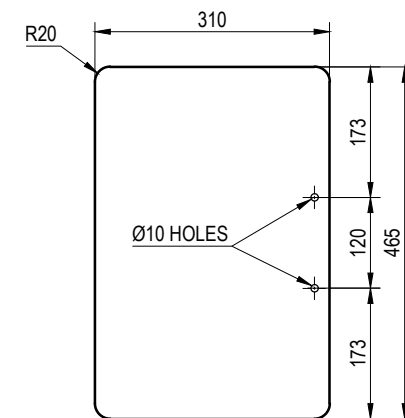

**INFORMATION PLATE
SIZE DETAILS**

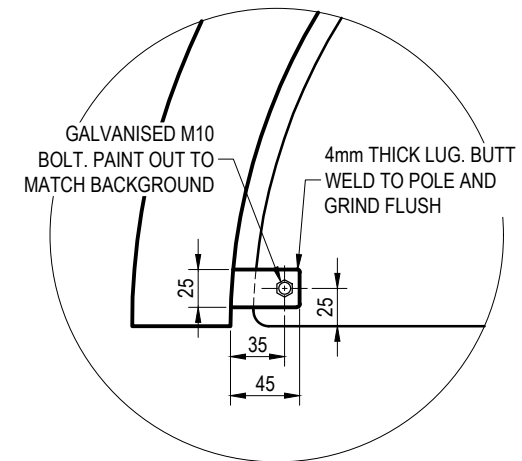

LUG DETAIL

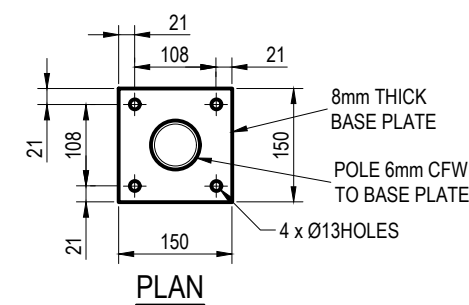

PLAN

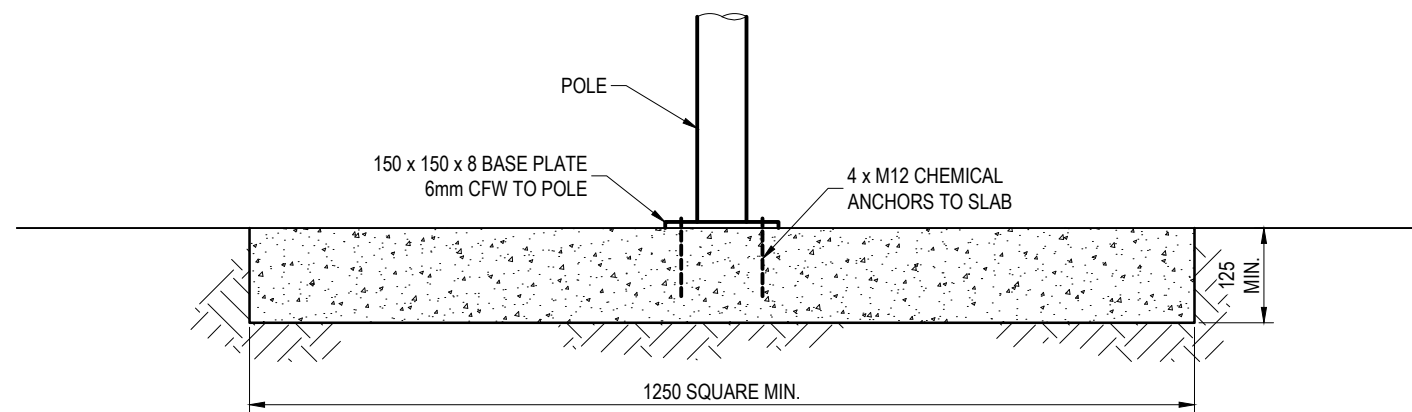

ELEVATION

ALTERNATIVE HOLD DOWN DETAIL

NOTES:

- REFER TO BRISBANE CITY COUNCIL TRANSPORT SIGNS MANUAL FOR STANDARD 'J' POLE GRAPHIC PANEL AND INFORMATION PLATE DETAILS.
- POLES TO BE POWDERCOATED AS FOLLOWS:
 - STOPS SERVICING EXPRESS, ROCKET AND GREAT CIRCLE LINE ROUTES: WHITE TO MATCH BCC 'WHITE 2'/AS2700 'N35 OFF WHITE' EQUIVALENT;
 - ALL OTHER STOPS: YELLOW TO MATCH BCC 'YELLOW 5'/AS 2700 'Y11 CANARY' EQUIVALENT.
- RETRO-REFLECTIVE TAPE TO BE WHITE FOR STOPS SERVICING EXPRESS, ROCKET AND GREAT CIRCLE LINE ROUTES, YELLOW FOR ALL OTHER STOPS (TO AS1906.2).
- IF ALTERNATIVE HOLD DOWN IS USED WITH EXISTING SLAB, SLAB TO BE MINIMUM 1250mm SQUARE AND 125mm THICK.
- ALL DIMENSIONS IN MILLIMETRES (U.N.O.).

ISSUE	AMENDMENT	DRAWN DATE	CHK'D DATE	APPR'D DATE
D	Dwg Title Amend., Sheet 2, Lug Detail & Bolt Holes Detail Add.. Notes 1 & 2 Updated	JAN '19	APR '19	
C	Notes revised (Noted 1 Mod)	MAR '16	JUL '16	JUL '16
B	Notes, Title and Dimensions Added	MAR '15	MAR '15	MAR '15
A	Drawing Converted from UMS Series April 2014	APR '14	APR '14	APR '14

DRAWING AUTHORISED FOR PUBLICATION
 P COTTON SIGNATURE ON ORIGINAL
 DATED 31/03/06
 MANAGER CITY ASSETS, R.P.E.Q: 2 5 4 6

DESIGN APPROVED
 B HANSEN SIGNATURE ON ORIGINAL
 DATED 28/02/06
 PRINCIPAL ENGINEER
 STRATEGIC ASSET MANAGEMENT

DESIGN	BCC (T & T)	DATE	Sept '04
DRAWN	CA (DJL)	DATE	Sept '04
CHECKED	CA (GMc)	DATE	Nov '05
DRAWING FILENAME	BSD-3104 (D) Bus Stop Marker 'J' Pole Post - Installation - Sheet 1 of 2		
ASSOCIATED PLANS	SUPERSEDES UMS 826		

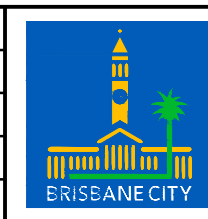

BRISBANE CITY COUNCIL STANDARD DRAWING	
BUS STOP MARKER 'J' POLE POST - DETAILS SHEET 1 OF 2	
SCALE	NOT TO SCALE
DWG No.	BSD-3104
ORIGINAL SIZE	A3
REVISION	D