

DETAIL A - FEMALE TONGUE
SCALE 1:2

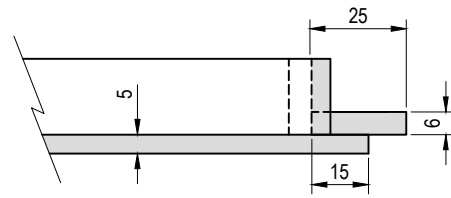

DETAIL B - MALE TONGUE
SCALE 1:2

SET BACK 15mm ON FRONT
EDGE ONLY. 6mm BACK ON ALL
OTHER EDGES

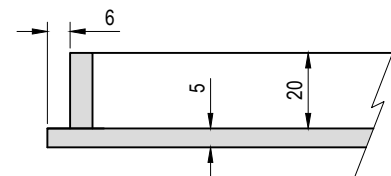

DETAIL C - SUPPORT BAR OFF SET
SCALE 1:2

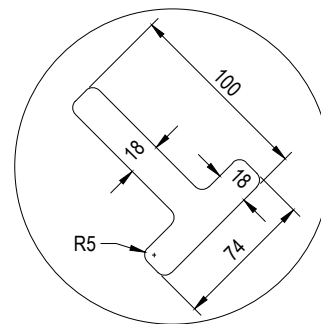

DETAIL D - TREE SPEAR CUT OUT DETAIL
SCALE 1:4

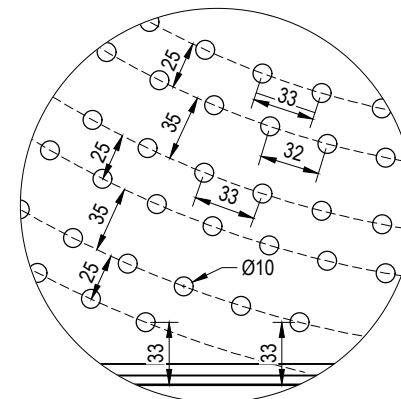

DETAIL E
SCALE 1:4

GENERAL NOTES

- GRATE ASSUMED TO NOT HAVE NOMINATED LOAD CLASSIFICATION AS PER AS3996. CARE TO BE TAKEN TO MINIMISE VEHICLE TRAFFIC LOADING. WHERE GRATE IS TO BE SUBJECTED TO VEHICLE LOADING, INSTALL CLASS 'C' LOAD RATED GRATE (WITH SURFACE PATTERN AS SHOWN) AND FRAME AS DESIGNED AND REVIEWED BY A SUITABLY QUALIFIED RPEQ.

TREE GRATE CONSTRUCTION NOTES

- TC1. TREE GRATE TO BE HOT SPRAYED GALVANISED PRIOR TO POWDER COATING.
- TC2. ALL WELDS TO BE MINIMUM 20mm IN LENGTH. ALL CORNERS TO HAVE VERTICAL DOWN WELDS.
- TC3. ALL SPLATTER & SLAG TO BE REMOVED PRIOR TO GALVANISING.
- TC4. HOLES ARE NOT TO BE WELDED OVER.
- TC5. ALL STRUCTURAL WELDS TO AS1554.
- TC6. CENTRALISE CAM LOCK PLATE OVER 32Ø HOLE BEFORE WELDING IN PLACE 2 OF PER GRATE HALF.
- TC7. POWERCOAT COLOUR TO BE 'INTERPON D1000 SABLE BASS TEXTURE GN297A'

TREE GRATE HOLE SETOUT NOTES

- TH1. LINE OFF SETS ARE STAGGERED BETWEEN 25mm & 35mm. GRATE EDGE TO CENTRE HOLE DISTANCE IS 33mm.
- TH2. CENTRE TO CENTRE HOLE DISTANCE IS APPROXIMATELY 32mm.
- TH3. DIVIDE HOLES PER LINE BY AMOUNTS OF HOLES NOT BY SET DISTANCES TO ACHIEVE A MORE UNIFORM HOLE PATTERN.
- TH4. HOLES TO BE 10mmØ.

INSTALLATION NOTES

- REFER TO BSD-9008 'TREE PIT WITH GRATE' FOR SUPPORT FRAME AND INSTALLATION.

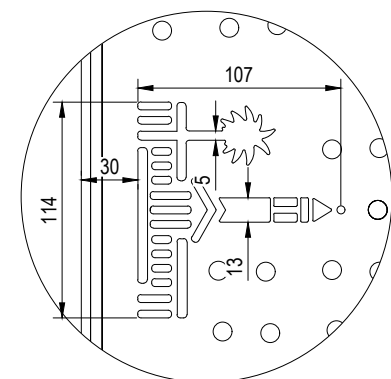

DETAIL F
SCALE 1:4

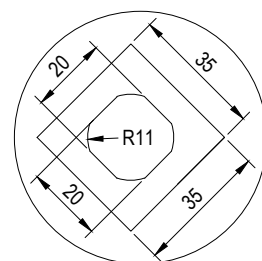

DETAIL G - CAM LOCK PLATE DETAIL
MATERIAL: 3mm STEEL (2 PER TREE HALF)
SCALE 1:4

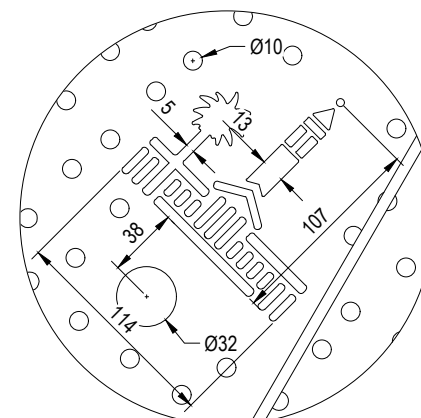

DETAIL H
SCALE 1:4

ISSUE	AMENDMENT	DRAWN DATE	CHK'D DATE	APPR'D DATE
C	General Notes (Note 1) Added	MAR '19	APR '19	APR '19
B	Drawing Title Amended	FEB '16	JUL '16	JUL '16
A	Drawing Converted from UMS Series April 2014	APR '14	APR '14	APR '14

DRAWING AUTHORISED FOR PUBLICATION
I. CONDRIK SIGNATURE ON ORIGINAL 06/2012
ASSET ENGINEERING MANAGER
STRATEGIC ASSET MANAGEMENT
DESIGN APPROVED
VICKI MARTIN SIGNATURE ON ORIGINAL
17/10/2011
PRINCIPAL OFFICER
URBAN DESIGN UNIT

DESIGN	Std Dwgs WG	DATE	OCT '13
DRAWN	CPD - P&D	DATE	OCT '13
CHECKED	D. M.	DATE	DEC '10
DRAWING FILENAME	BSD-9071 (C) Tree grate - Details - Sheet 2 of 3.dwg		
ASSOCIATED PLANS	SUPERSEDES UMS-519-2		

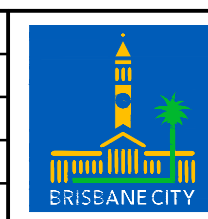

BRISBANE CITY COUNCIL STANDARD DRAWING	
SCALE	NOT TO SCALE
DWG No.	BSD-9071
ORIGINAL SIZE	A3
REVISION	C

TREE GRATE
DETAILS
SHEET 2 OF 3