

TOP VIEW

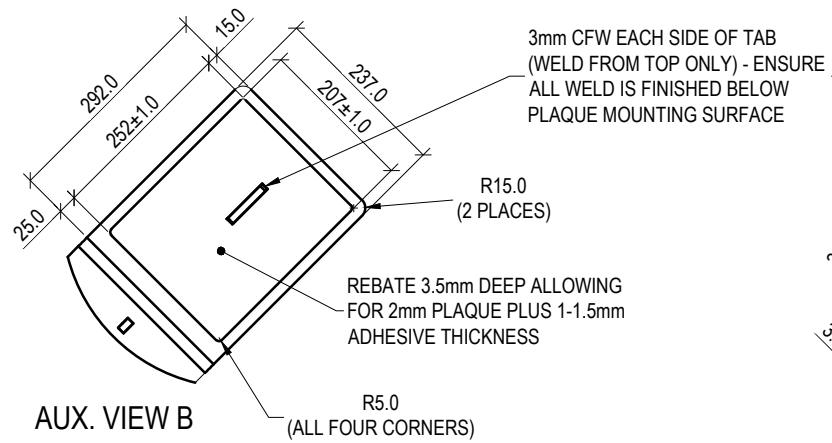

AUX. VIEW B R5.0 (ALL FOUR CORNERS)

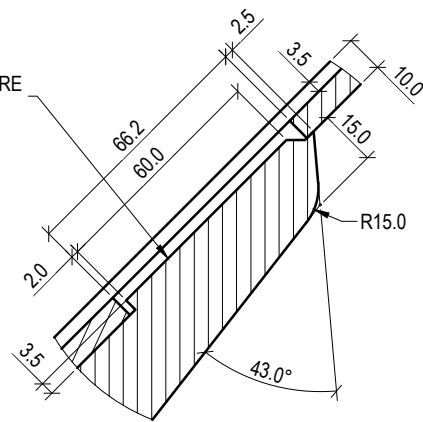

DETAIL D SCALE 1 : 2

ATTRIBUTION PLAQUE (REFER TO BSD-7344) GLUE IN PLACE WITH SIKAFLEX 11FC OR EQUIVALENT FOR HIGH STRENGTH BOND

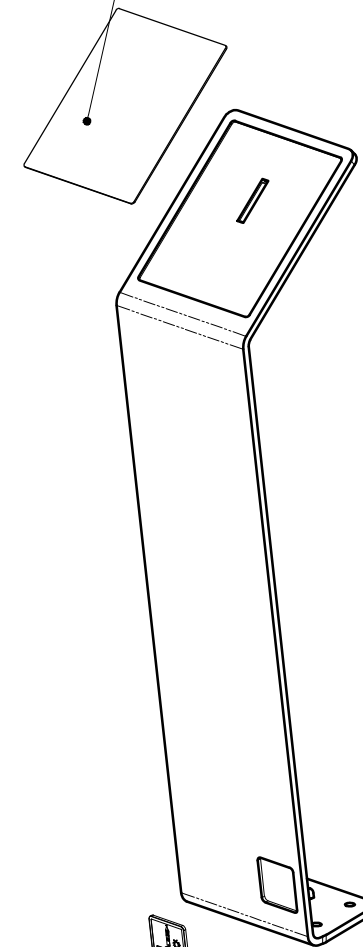

LOGO BADGE (REFER TO SHEET 6) GLUE IN PLACE WITH SIKAFLEX 11FC OR EQUIVALENT FOR HIGH STRENGTH BOND

STANDARDS

DESIGNED IN ACCORDANCE WITH, AND FABRICATION TO MEET THE FOLLOWING STANDARDS:

1. GUIDE TO ENGINEERING PRACTICE, 'PEDESTRIANS', PART 13, AUSTRROADS.
2. AS1627.4 METAL FINISHING - PREPARATION AND PRE-TREATMENT OF SURFACES - ABRASIVE BLAST CLEANING OF STEEL.
3. AS2312:2002/AMDT 1:2004, GUIDE TO PROTECTION OF IRON AND STEEL AGAINST EXTERIOR ATMOSPHERIC CORROSION, 1994.
4. AUSTRALIAN ROAD RULES, 1999, WWW.NRTC.GOV.AU
5. AS4506 -2005, METAL FINISHING-THERMOSET POWDER COATINGS.
6. AS4680:2006, HOT DIP GALVANISING.

NOTES

1. WELDING TO BE IN ACCORDANCE WITH AS1554.1 CAT GP WELDING, ALL SHARP EDGES & BURRS REMOVED.
2. PART SHOULD BE SUPPLIED CLEAN AND FREE FROM MARKS, BURRS, SCUFFS, DISTORTION AND WARPAGE.
3. DRAWING TO AS1100 DRAWING STANDARDS.
4. REFER TO DRAWING SHEET 4 FOR INSTALLATION DETAILS.
5. ALL TOLERANCES $\pm 1.5\text{mm}$ UNLESS OTHERWISE SPECIFIED.

MATERIAL

1. MATERIAL: 10mm MILD STEEL PLATE
2. COLOUR: DULUX 'METROPOLIS STORM PEARL' OR APPROVED EQUIVALENT
3. FINISH: GALVANISED AND POWDERCOATED

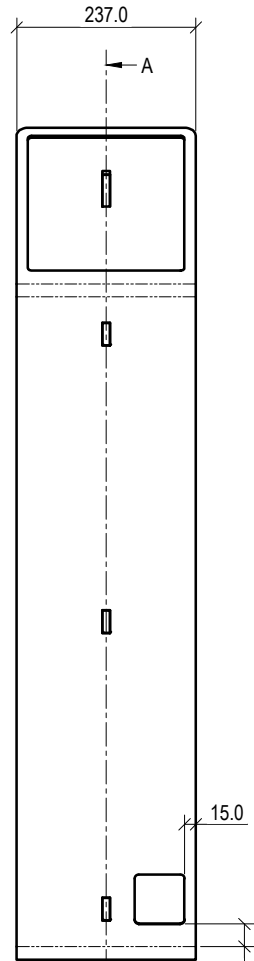

FRONT VIEW

REBATE FOR BADGE 66 x 66 x 5mm DEEP

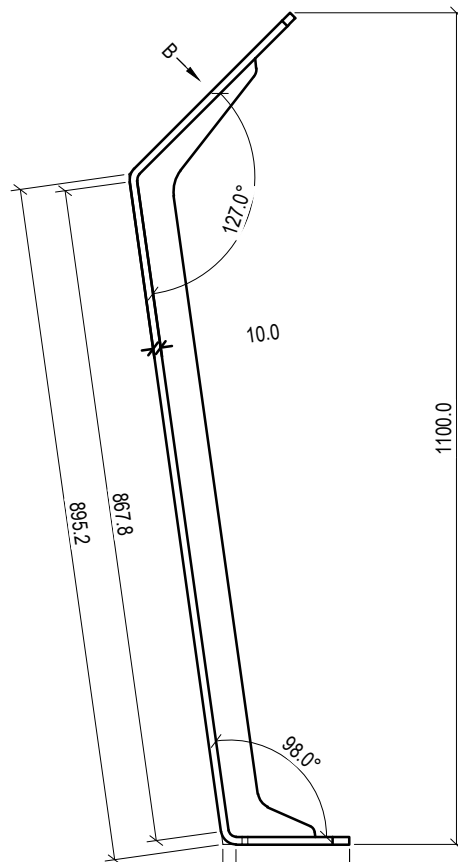

SIDE VIEW

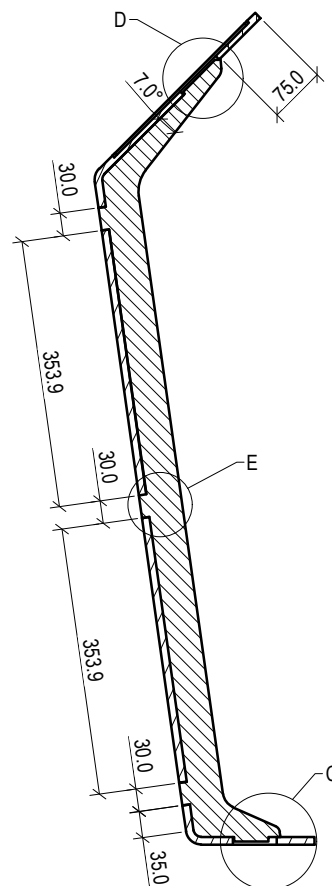

SECTION A-A

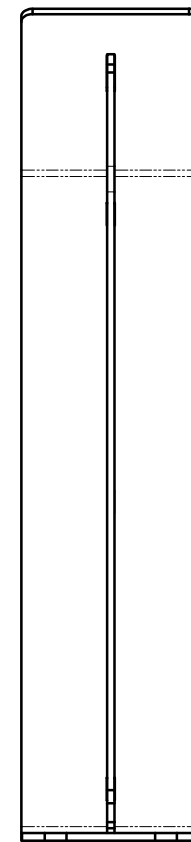

REAR VIEW

FULLY WELD FROM FRONT AND FINISH BACK FLUSH PRIOR TO GALVANISING AND POWDERCOATING

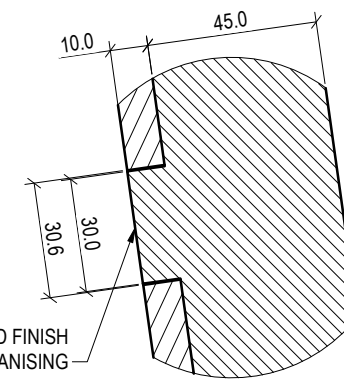

DETAIL E SCALE 1 : 2 WELD TAB - 2 PLACES

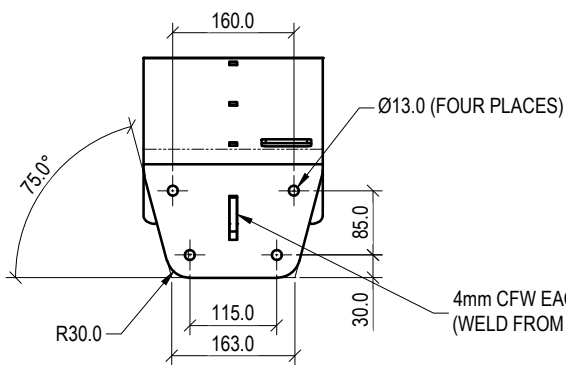

UNDERSIDE VIEW

4mm CFW EACH SIDE OF TAB (WELD FROM UNDERSIDE ONLY)

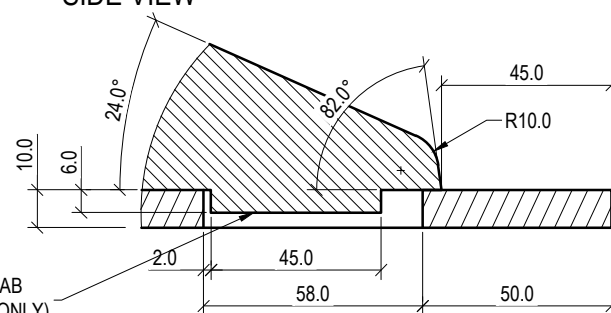

DETAIL C SCALE 1 : 2



BRISBANE CITY COUNCIL STANDARD DRAWING

ATTRIBUTION STAND - TYPE 1
SHEET 1 OF 6

PUBLISH DATE	
SCALE 1:10	
DRAWING NUMBER BSD-7341	
ORIGINAL SIZE A3	REVISION A