

## STANDARDS

DESIGNED IN ACCORDANCE WITH, AND FABRICATION TO MEET THE FOLLOWING STANDARDS:

1. GUIDE TO ENGINEERING PRACTICE, 'PEDESTRIANS', PART 13, AUSTRROADS.
2. AS1627.4 METAL FINISHING - PREPARATION AND PRE-TREATMENT OF SURFACES - ABRASIVE BLAST CLEANING OF STEEL.
3. AS2312:2002/AMDT 1:2004, GUIDE TO PROTECTION OF IRON AND STEEL AGAINST EXTERIOR ATMOSPHERIC CORROSION, 1994.
4. AUSTRALIAN ROAD RULES, 1999, WWW.NRTC.GOV.AU
5. AS4506 -2005, METAL FINISHING-THERMOSET POWDER COATINGS.
6. AS4680:2006, HOT DIP GALVANISING.

## NOTES

1. WELDING TO BE IN ACCORDANCE WITH AS1554.1 CAT GP WELDING, ALL SHARP EDGES & BURRS REMOVED.
2. PART SHOULD BE SUPPLIED CLEAN AND FREE FROM MARKS, BURRS, SCUFFS, DISTORTION AND WARPAGE.
3. DRAWING TO AS1100 DRAWING STANDARDS.
4. REFER TO DRAWING SHEET 4 FOR INSTALLATION DETAILS.
5. ALL TOLERANCES  $\pm 1.5\text{mm}$  UNLESS OTHERWISE SPECIFIED.

## MATERIAL

1. MATERIAL: 10mm MILD STEEL PLATE
2. COLOUR: DULUX 'METROPOLIS STORM PEARL' OR APPROVED EQUIVALENT
3. FINISH: GALVANISED AND POWDERCOATED

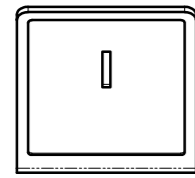

TOP VIEW

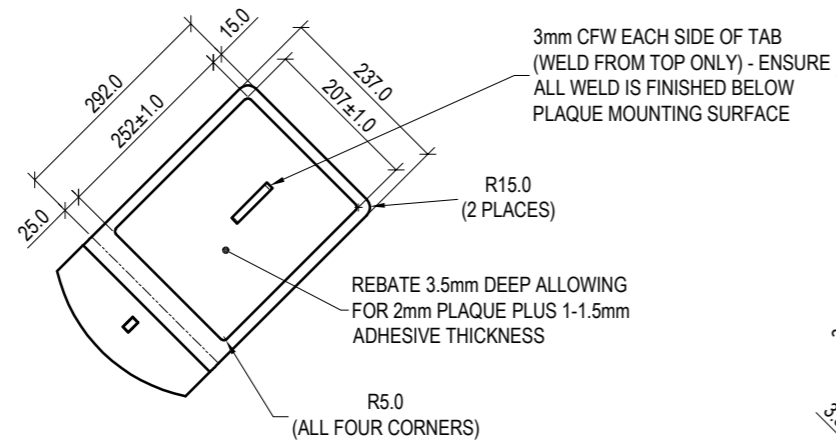

AUX. VIEW B

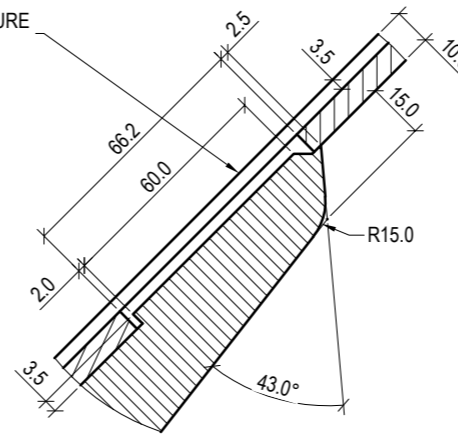

DETAIL D  
SCALE 1 : 2

ATTRIBUTION PLAQUE (REFER TO BSD-7344) GLUE IN PLACE WITH SIKAFLEX 11FC OR EQUIVALENT FOR HIGH STRENGTH BOND

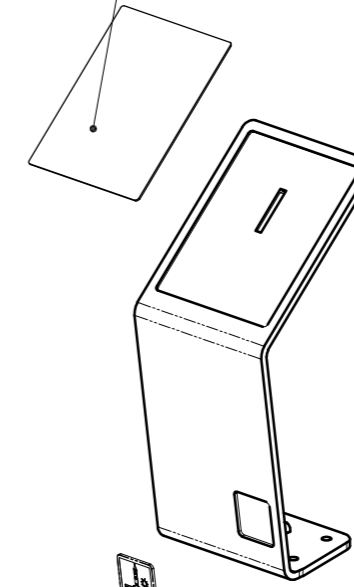

LOGO BADGE (REFER TO BSD-7341 SHEET 6) GLUE IN PLACE WITH SIKAFLEX 11FC OR EQUIVALENT FOR HIGH STRENGTH BOND

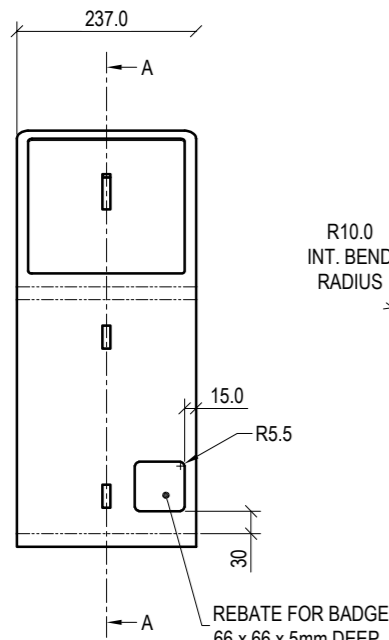

FRONT VIEW

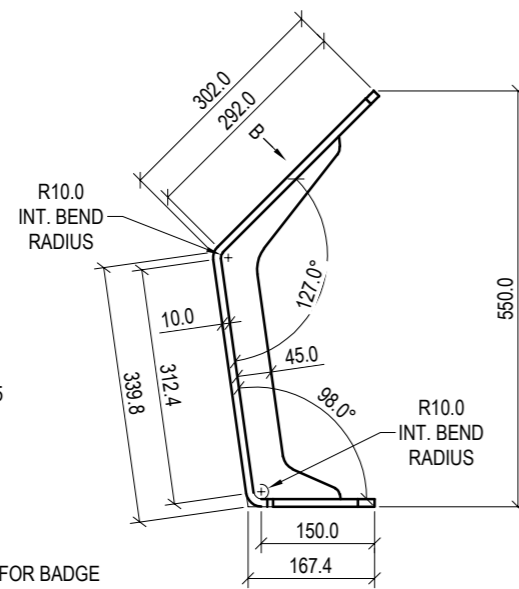

SIDE VIEW

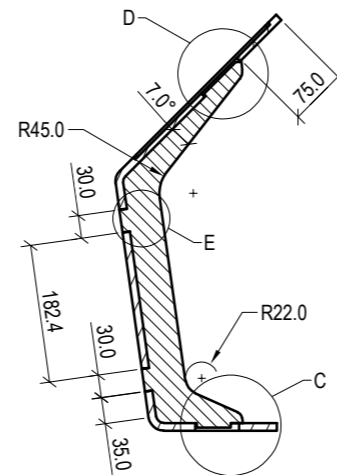

SECTION A-A

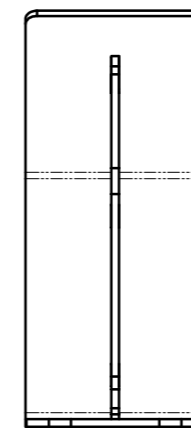

REAR VIEW

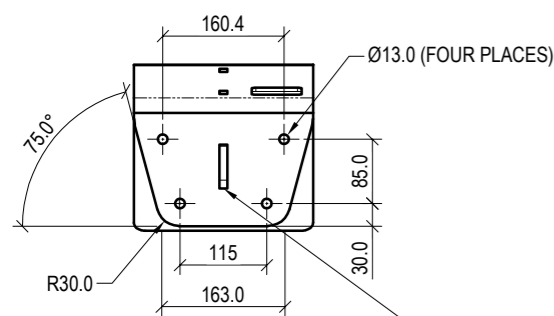

UNDERSIDE VIEW

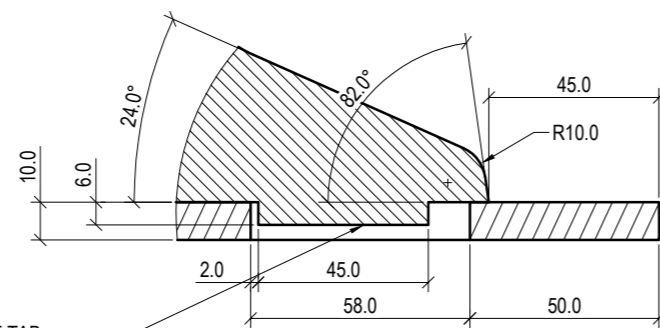

DETAIL C  
SCALE 1 : 2

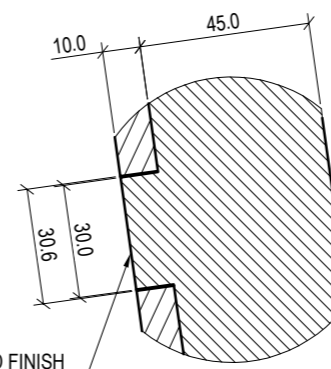

FULLY WELD FROM FRONT AND FINISH BACK FLUSH PRIOR TO GALVANISING AND POWDERCOATING

DETAIL E  
SCALE 1 : 2  
WELD TAB - 2 PLACES

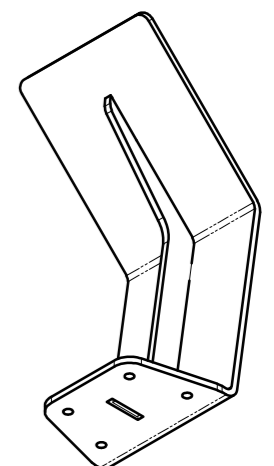
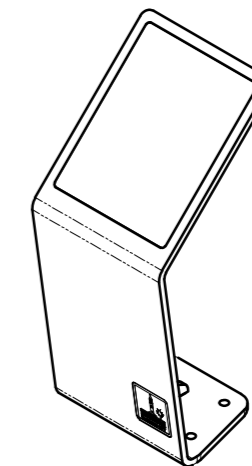

BRISBANE CITY COUNCIL STANDARD DRAWING

ATTRIBUTION STAND - TYPE 2  
SHEET 2 OF 6

PUBLISH DATE	
SCALE 1:10	
DRAWING NUMBER BSD-7341	
ORIGINAL SIZE A3	REVISION A