

DIMPLE PROFILE
SCALE 1:5

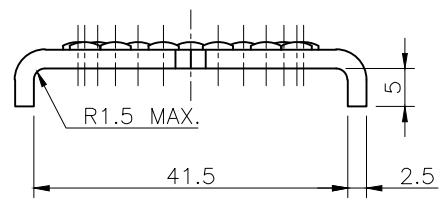

TYPE 1 LOCK WASHER

STANDARD LOCK WASHER FOR LANTERN
MOUNTING STRAP AND LOWER MOUNTING
BRACKET

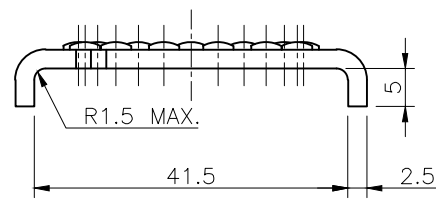

TYPE 2 LOCK WASHER

SPECIAL LOCK WASHER FOR T-BAR ASSEMBLIES
FOR DUAL LANTERNS
(REFER NOTE 5)

NOTES:

- REMOVE SHARP CORNERS AND EDGES.
- MATERIAL: STAINLESS STEEL GRADE 304 2B DULL.
- FINISH: NATURAL.
- TOLERANCE UNLESS OTHERWISE STATED:
 - GENERAL DIMENSIONS $\pm 0.5\text{mm}$
 - ANGULAR $\pm 1^\circ$
- TYPE 2 LOCK WASHER TO BE USED ONLY FOR THE TEE-BAR ASSEMBLY FOR DUAL LANTERNS.
- ALL DIMENSIONS IN MILLIMETRES (U.N.O.).

ISSUE	AMENDMENT	DRAWN DATE	CHK'D DATE	APPR'D DATE
A	Drawing Converted from UMS Series April 2014	APR '14	APR '14	APR '14

DRAWING AUTHORISED FOR PUBLICATION			
P COTTON SIGNATURE ON ORIGINAL			
MANAGER CITY ASSETS - R.P.E.Q: 2 5 4 6			
DESIGN APPROVED			
I. CONDRIK SIGNATURE ON ORIGINAL DATED 12/10			
PRINCIPAL ENGINEER ROAD NETWORK INFRASTRUCTURE - R.P.E.Q: 8 5 2 1			
DESIGN	Std Dwgs WG	DATE	April '09
DRAWN	CPD - P&D	DATE	April '09
CHECKED	I. Condric	DATE	Dec'10
DRAWING FILENAME	BSD-4106.dwg		
ASSOCIATED PLANS	SUPERSEDES UMS-600-045		



BRISBANE CITY COUNCIL STANDARD DRAWING	
LOCK WASHERS	
SCALE	NOT TO SCALE
DWG No.	BSD-4106
ORIGINAL SIZE	A3
REVISION	A