

GENERAL NOTES

- Detail to be incorporated in developments where:
 - 2 or more trees are being installed along the road frontage.
 - Services permit/enable the construction of the trench
 - Sub-surface drainage can be connected and drained to the stormwater system.
- Refer to BSD-9008 for details on tree species and tree grate specifications.
- Tree pit to be installed to full depth and width where possible.
- Ensure services have been located prior to excavation. If tree location conflicts with service consult with service provider.
- Refer to BSD-9008 for backfill soil blend specification (outside of modular soil cell).
- Where possible incorporate WSUD detail to capture street water. Refer to BSD-9031.
- Refer to BSD-5202 for concrete and reinforcing mesh details unless noted otherwise.
- Modular soil cell is to be structurally certified to carry loads of 10t minimum. Cell is to provide at least 90% free soil volume, with positive vertical and lateral interlocks (and have a minimum of 100mm gaps to allow for root growth) installed as per manufacturer's instructions. Cells are to be backfilled with filler soil as specified by modular cell supplier. Soil is to comply with AS 4419.

Tree species as specified, refer to Infrastructure Design Planning Scheme Policy. Set out for approval by Landscape Architect prior to planting.

PVC riser as per BSD-8305.

Tree grate as per BSD-9008.

Footpath as per BSD-5202.

STRUCTURAL DESIGN REVIEWED AND CERTIFIED FOR ISSUE
 NAME: B. BALAKUMAR RPEQ: 3963
 SIGNATURE: SIGNATURE ON ORIGINAL DATE: 28/07/10

Modular soil cell system as per manufacturer's instructions. Extent of required area depends upon size of rootball and constraints. Backfill with soil media as per General Notes.

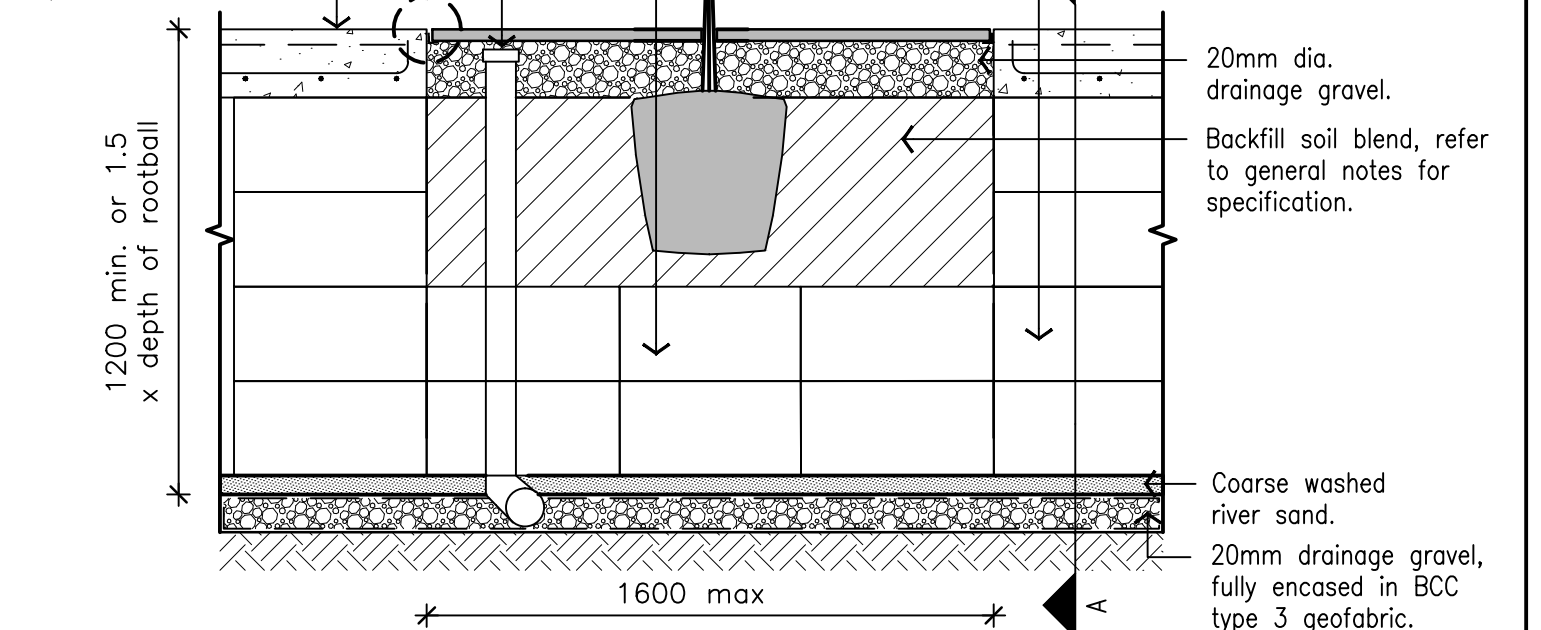

CROSS SECTION B-B

PLAN

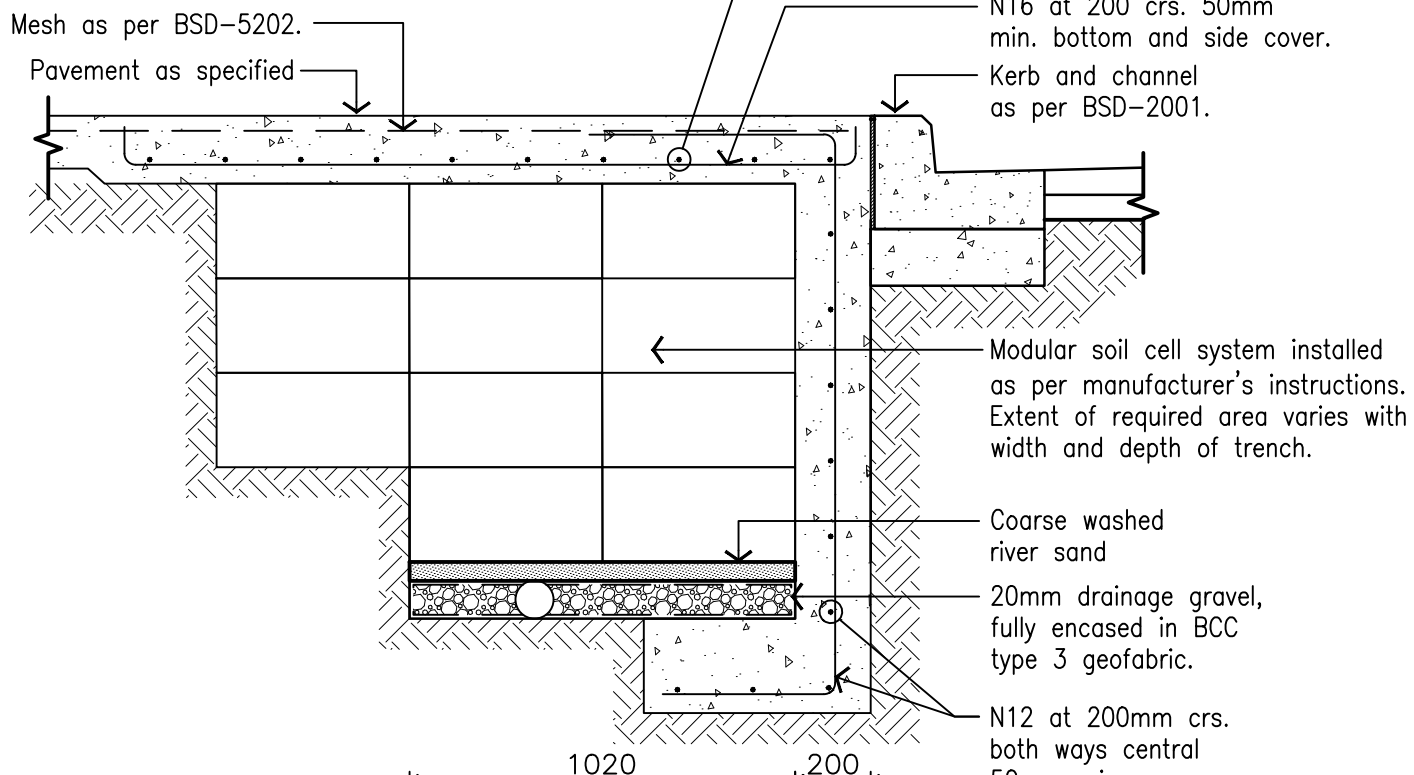

CROSS SECTION A-A

ISSUE	AMENDMENT	DRAWN DATE	CHK'D DATE	APPR'D DATE
B	Updated Superseded Reference in Drawing details	MAY '17	MAY '17	MAY '17
A	Drawing Converted from UMS Series April 2014	APR '14	APR '14	APR '14

DRAWING AUTHORISED FOR PUBLICATION P. COTTON SIGNATURE ON ORIGINAL				DESIGN	Std Dwgs WG	DATE	JUN '10
ASSET ENGINEERING MANAGER STRATEGIC ASSET MANAGEMENT				DRAWN	CPO - P&D	DATE	JUN '10
DESIGN APPROVED V. MARTIN SIGNATURE ON ORIGINAL DATED 06/9/10				CHECKED	D. K.	DATE	JUN '10
PRINCIPAL OFFICER URBAN DESIGN UNIT				DRAWING FILENAME	BSD-9012 (A) Tree trench - Type 3 structural cells.dwg		
				ASSOCIATED PLANS	SUPERSEDES UMS-518-3		

BRISBANE CITY COUNCIL STANDARD DRAWING

SCALE: NOT TO SCALE

DWG No. **BSD-9012**

ORIGINAL SIZE: A3 REVISION: A

TREE TRENCH - TYPE 3 STRUCTURAL CELLS