

STANDARDS

DESIGNED IN ACCORDANCE WITH, AND FABRICATION TO MEET THE FOLLOWING STANDARDS:

1. AS1428.4.1:2009, TACTILE GROUND SURFACE INDICATORS FOR THE ORIENTATION OF PEOPLE WITH VISION IMPAIRMENT.
2. AS1627.4 METAL FINISHING – PREPARATION AND PRE-TREATMENT OF SURFACES – ABRASIVE BLAST CLEANING OF STEEL.
3. AS2312:2002/AMDT 1:2004, GUIDE TO PROTECTION OF IRON AND STEEL AGAINST EXTERIOR ATMOSPHERIC CORROSION, 1994.
4. GUIDE TO ENGINEERING PRACTICE, 'PEDESTRIANS', PART 13, AUSTRROADS. AUSTRALIAN ROAD RULES , 1999, WWW.NRTC.GOV.AU
5. AS4506 –2005, METAL FINISHING– THERMOSET POWDER COATINGS.
6. AS4680:2006, HOT DIP GALVANISING.
7. AS1742.9–2000, MANUAL OF UNIFORM TRAFFIC CONTROL DEVICES, 'BICYCLE FACILITIES'
8. GUIDE TO ENGINEERING PRACTICE, 'BICYCLES', PART 14, AUSTRROADS. AUSTRALIAN ROAD RULES , 1999, WWW.NRTC.GOV.AU
9. AS2890.3–1993 PARKING FACILITIES PART 3
10. AS 1742.9– 2000 MANUAL OF UNIFORM TRAFFIC CONTROL DEVICES PART 9: BIKE FACILITIES

NOTES

1. WELDING TO BE ACCORDANCE TO AS1554.1 CAT GP WELDING, ALL SHARP EDGES & BURRS REMOVED.
2. PART SHOULD BE SUPPLIED CLEAN AND FREE FROM MARKS, BURRS, SCUFFS, DISTORTION AND WARPAGE.
3. ENSURE ANTI-SEIZE IS ON ALL NUTS AND BOLTS PRIOR TO ASSEMBLY.
4. DRAWING TO AS1100 DRAWING STANDARDS.
5. 316 S.S AND 316 S.S FASTENERS TO BE USED THROUGHOUT FOR COASTAL INSTALLATIONS OR ANY ENVIRONMENT WITH HIGH CORROSION.
6. ALL TOLERANCES $\pm 1.5\text{mm}$ UNLESS OTHERWISE SPECIFIED.

MATERIAL

1. MATERIAL: MILD STEEL
2. COLOUR: 'DULUX' METROPOLIS 'STORM PEARL' OR APPROVED EQUIVALENT
3. FINISH: GALVANISED AND POWDER COATED

STRUCTURAL DESIGN REVIEWED AND CERTIFIED FOR ISSUE

NAME: B.C. PLANT RPEQ: 8807
SIGNATURE: ON ORIGINAL DATE: 28/6/12

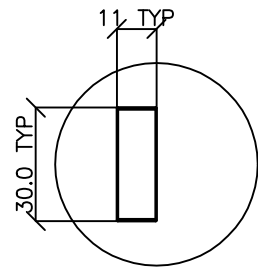

DETAIL A
KEYWAY DETAIL
SCALE 1 : 2

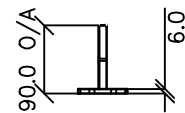

TOP VIEW

RADIUS ALL FORWARD FACING EDGES (MIN RADIUS 3MM)

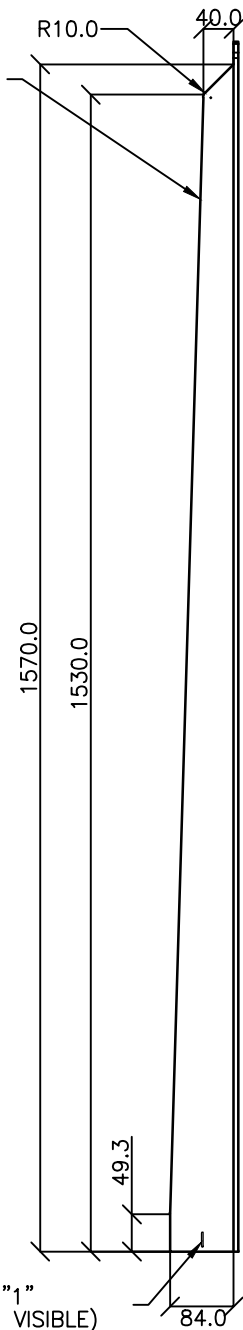

SIDE VIEW

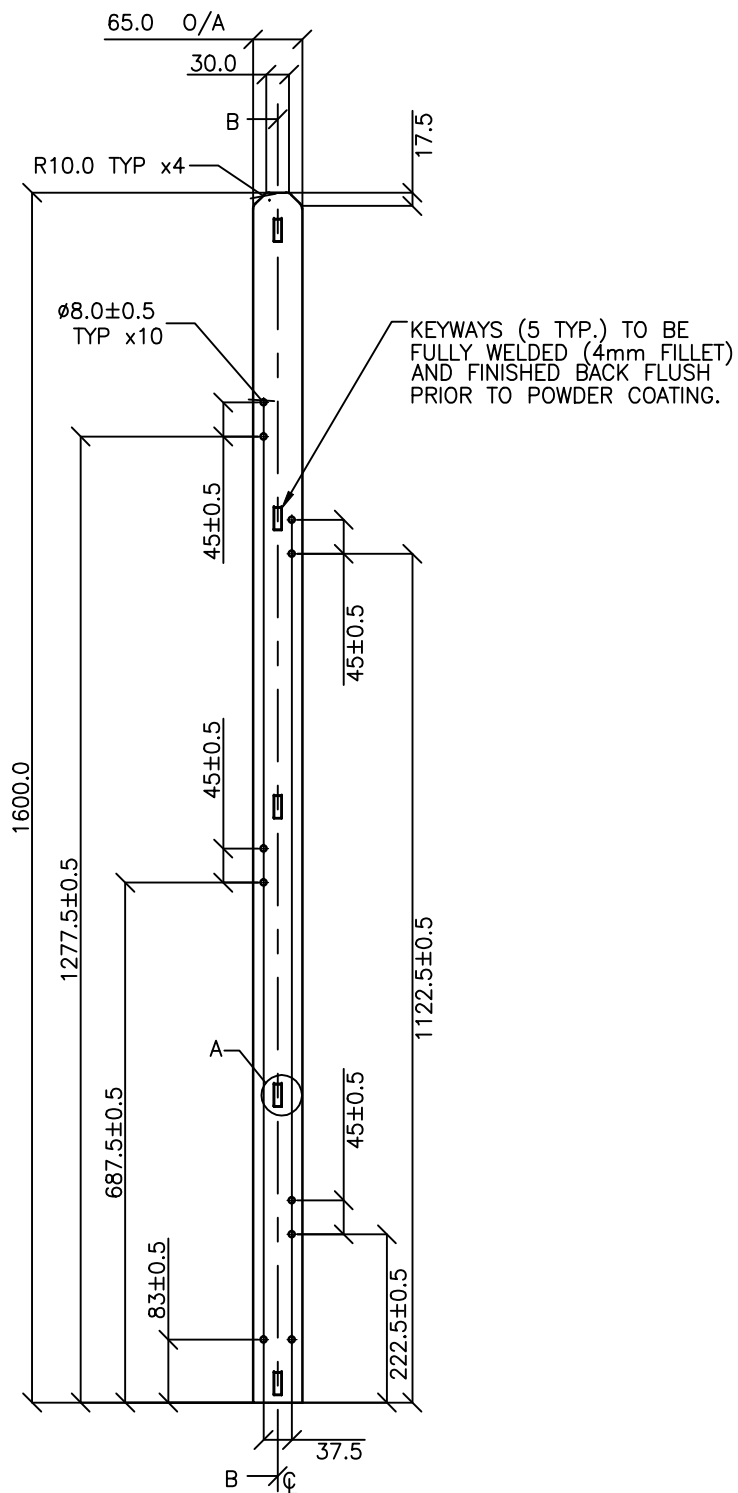

FRONT VIEW

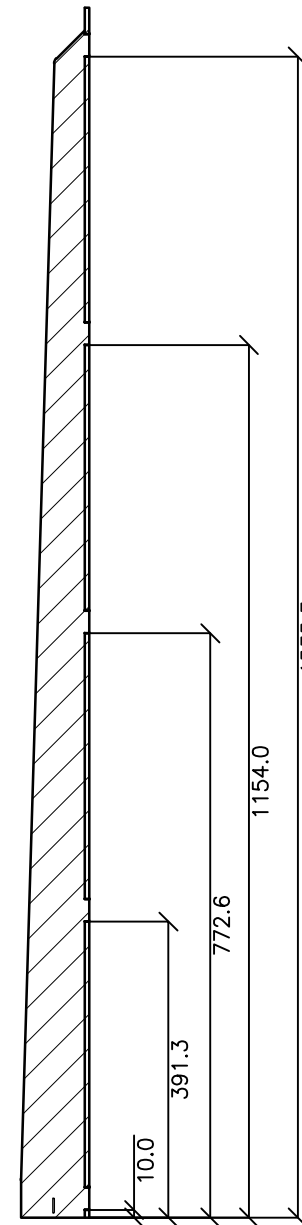

SECTION B-B

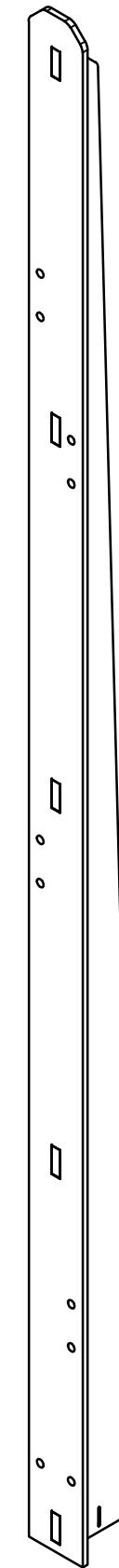

PICTORIAL VIEW
SCALE 1 : 6

LASER CUT OR STAMPED NUMBER "1" (MUST BE CLEARLY VISIBLE)

ISSUE	AMENDMENT	DRAWN DATE	CHK'D DATE	APPR'D DATE
C	Colour Finish Requirements Updated (Material Notes)	MAY '17	MAY17	MAY '17
B	Drawing Title Amended	FEB '16	JUL '16	JUL 16
A	Drawing Converted From UMS Sereis April 2014	APR'14	APR'14	APR'14

DRAWING AUTHORISED FOR PUBLICATION INGA CONDRIK AUTHORISED 15/04/2014				DESIGN	FORMZOO DESIGN	DATE	June '12
FOR ASSET ENGINEERING MANAGER STRATEGIC ASSET MANAGEMENT				DRAWN	AB	DATE	June '12
DESIGN APPROVED				CHECKED	VM	DATE	04/13
VICKI MARTIN SIGNATURE ON ORIGINAL				DRAWING FILENAME	BSD-9072 (B) Tree guard - No 1 upright - Sheet 2 of 8.dwg		
PRINCIPAL PLANNING OFFICER URBAN DESIGN				ASSOCIATED PLANS	SUPERSEDES UMS 520 Series		

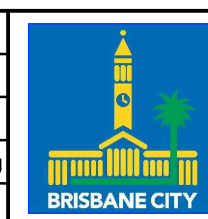

BRISBANE CITY COUNCIL STANDARD DRAWING	
TREE GUARD NO 1 UPRIGHT SHEET 2 OF 8	
SCALE 1:10	DWG No. BSD-9072
ORIGINAL SIZE A3	REVISION C