

2 RAIL ARIS FENCE

NOTES:

1. THIS STANDARD IS NOT FOR USE IN A MARINE ENVIRONMENT. THE MARINE ENVIRONMENT COULD EXTEND UP TO 1km FROM THE FORESHORE.
2. POSTS AND ARIS FENCE TOP RAIL TO BE 74x74 GALVANISED BASED COLORBOND SQUARE HOLLOW SECTION.
3. ALL OTHER RAILS TO BE 108x38 GALVANISED BASED COLORBOND RECTANGULAR HOLLOW SECTION.
4. JOINTS AND CONNECTIONS TO MANUFACTURERS SPECIFICATIONS.
5. POSTS TO BE VERTICAL.
6. ALL CONCRETE TO BE GRADE N25.
7. TWO RAIL POST AND RAIL FENCES GENERALLY USED AS PEDESTRIAN PROTECTION ABOVE CULVERTS AND EMBANKMENTS AND AS VEHICLE DELINEATION ALONG SPLIT-LEVEL STREETS.
8. THESE FENCES ARE INTENDED AS A PEDESTRIAN BARRIER AND DELINEATION DEVICE AND ARE NOT TO BE USED IN SITUATIONS WHERE VEHICLES REQUIRE RESTRAINT.
9. STEEL POSTS AND RAILS MAYBE POWDER COATED TO AS 4506 TO MATCH COLOUR CO-ORDINATION IN THE AREA (IN ACCORDANCE WITH BCC CORPORATE COLOUR PALETTE, REFER BSD-1003).
10. 100mm WIDE REFLECTIVE TAPE TO BE APPLIED TO END POSTS AND/OR TERMINAL END OF RAILS WHERE VEHICLE TRAFFIC CONFLICT MAY OCCUR.
11. DIMENSIONS IN MILLIMETRES (U.N.O.).

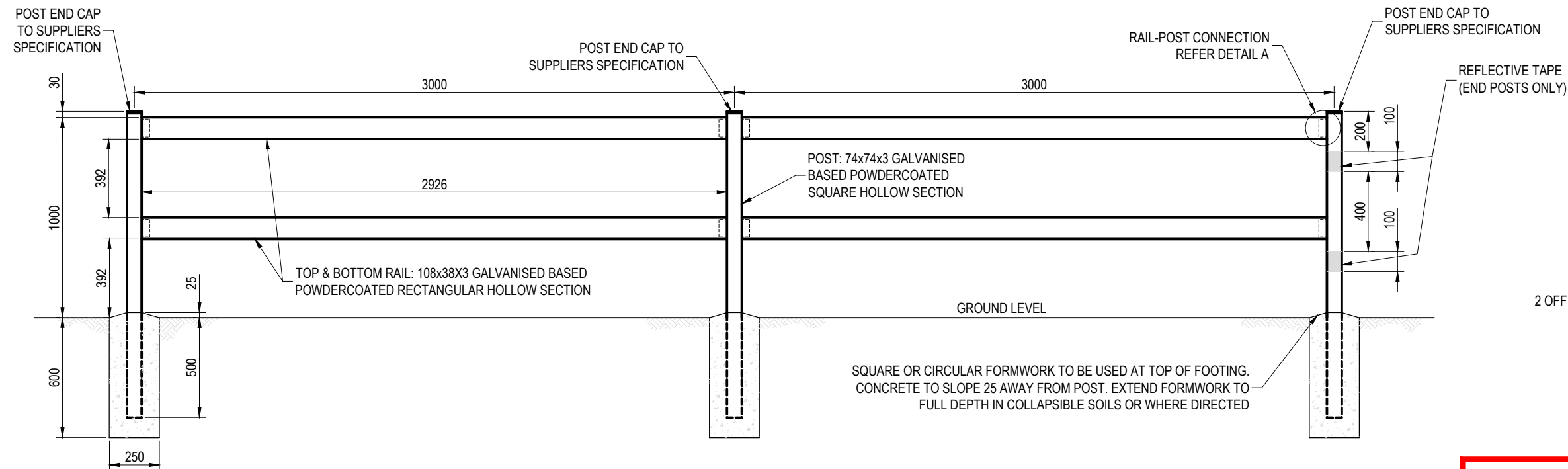

2 RAIL FENCE

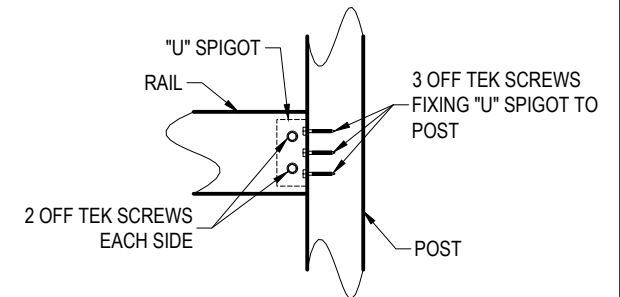

DETAIL A

SPECIAL NOTE

TWO RAIL POST AND RAIL FENCING TO BE USED ONLY IN SITUATIONS CLEAR OF POTENTIAL VEHICLE IMPACT OR NOT WITHIN THE CLEAR ZONE SO AS NOT TO BE A HAZARD TO VEHICLES. WHERE A SITUATION SUCH AS THIS EXISTS, A WELDED MESH FENCE IS TO USED - REFER BSD-7002.

| ISSUE | AMENDMENT | DRAWN DATE | CHK'D DATE | APPR'D DATE |
|-------|--|------------|------------|-------------|
| C | Special Notes Added | JAN '19 | APR '19 | APR '19 |
| B | Drawing Title Amended | FEB '16 | JUL '16 | JUL '16 |
| A | Drawing Converted from UMS Series April 2014 | APR '14 | APR '14 | APR '14 |

DRAWING AUTHORISED FOR PUBLICATION
 PAUL COTTON SIGNATURE ON ORIGINAL
 DATED 03/03/05 R.P.E.Q: 2546

ASSET ENGINEERING MANAGER
 STRATEGIC ASSET MANAGEMENT

DESIGN APPROVED
 BRUCE HANSEN SIGNATURE ON ORIGINAL
 DATED MAR '05

PRINCIPAL ENGINEER
 STRATEGIC INFRASTRUCTURE MANAGEMENT

| | | | |
|------------------|---|------|---------|
| DESIGN | UMD-IM (DL) | DATE | FEB '04 |
| DRAWN | UMD-IM (DL) | DATE | FEB '04 |
| CHECKED | BH | DATE | MAR '05 |
| DRAWING FILENAME | BSD-7005 (C) Fence - Two rail, steel hollow section post and rail.dwg | | |
| ASSOCIATED PLANS | SUPERSEDES UMS-248 | | |



| | |
|--|-----------------|
| BRISBANE CITY COUNCIL STANDARD DRAWING | |
| FENCE - TWO RAIL, STEEL HOLLOW SECTION POST AND RAIL FENCE | |
| SCALE | NOT TO SCALE |
| DWG No. | BSD-7005 |
| ORIGINAL SIZE | REVISION |
| A3 | C |