

STANDARD TYPE 'E'

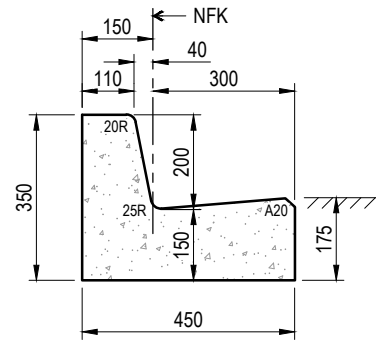

200 TYPE 'E'
USED ADJACENT TO PARKS
(WHERE CARRIAGEWAY WIDTH IS ≥ 7.5m)

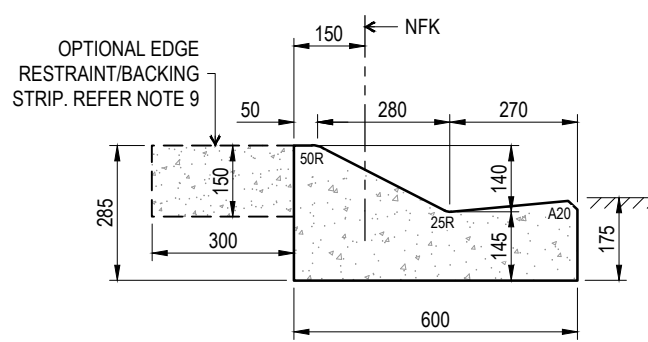

TYPE 'D'

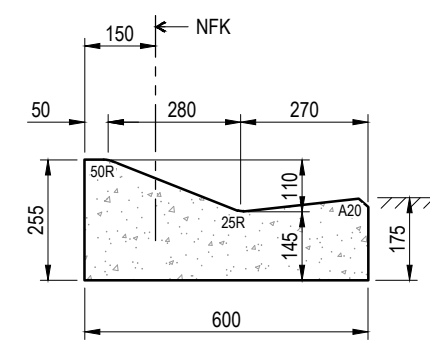

TYPE 'F' LOWER MOUNTABLE
USED FOR FOREST LAKE ONLY (NON BUS
ROUTES).

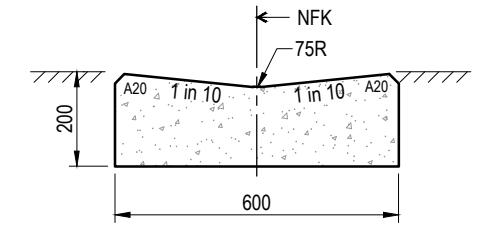

INVERT

KERB AND CHANNEL

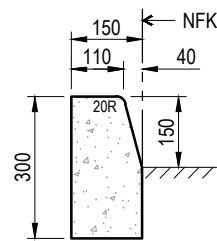

STANDARD TYPE 'E'
USED WHERE ONE-WAY CROSSFALL
NEGATES USE OF CHANNEL.

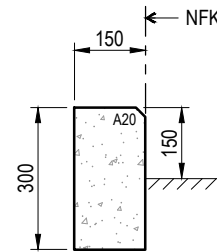

VERTICAL TYPE 'E'
USED AS PER "STANDARD TYPE 'E' KERB"
TO MATCH EXISTING OLD PROFILE.

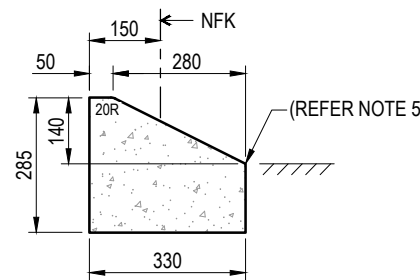

TYPE 'D'
USED WHERE ONE WAY CROSSFALL
NEGATES USE OF CHANNEL.

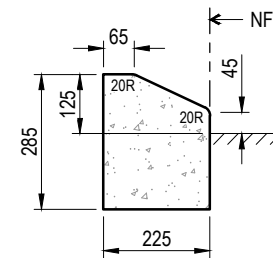

TYPE 'F'
USED FOR FOREST LAKE ONLY (NON BUS
ROUTES).

NOTES:

1. MACHINE PLACED (SLIP FORMED OR EXTRUDED) CONCRETE TO BE GRADE S32, MINIMUM CEMENT CONTENT OF THE CONCRETE TO BE 320kg/m³.
2. KERB PROFILES TO BE INSTALLED AS PER THE INFRASTRUCTURE DESIGN PLANNING SCHEME POLICY (IDPSP).
3. PRECAST OR HAND PLACED (IN SITU) CONCRETE TO BE GRADE N25.
4. THE EXTENT OF HAND PLACED (IN SITU) CONCRETE MUST NOT EXCEED 20m IN CONTIGUOUS LENGTHS (INCLUDING VEHICULAR ENTRANCES AND KERB RAMPS).
5. FOR 230 x 280 EDGE RESTRAINT, PROVIDE A MINIMUM DEPTH OF 230mm CLEAR OF ANY PAVER THICKNESS.
6. A NARROW CHANNEL MAY BE ADDED TO TYPE 'D' KERB PROFILE IF APPROVED.
7. PROVIDE CONTRACTION OR SHRINKAGE CONTROL JOINTS AT REGULAR INTERVALS NOT EXCEEDING 4m, BY FORMING GROOVES 40mm DEEP BY 6mm WIDE.
8. PROVIDE EXPANSION JOINTS WHERE THE KERB AND CHANNEL ABUTS SUBSTANTIAL EXISTING STRUCTURES SUCH AS BRIDGES, OR WHERE DIRECTED. WHERE RELEVANT, LOCATE JOINTS TO LINE UP WITH THE EXPANSION JOINTS IN ADJACENT STRUCTURES SUCH AS RIGID PAVEMENTS AND CONCRETE SLABS. CONSTRUCT JOINTS BY INSTALLING 10mm THICK COMPRESSIBLE PACKING FOR THE FULL WIDTH AND DEPTH OF THE KERB AND CHANNEL.
9. OPTIONAL EDGE RESTRAINT/BACKING STRIP MAY BE USED FOR KERB AND CHANNEL WITH LANDSCAPING BEHIND.
10. DIMENSIONS IN MILLIMETRES (U.N.O.).

LEGEND

A20	20 ARRIS
25R	25 RADIUS
50R	50 RADIUS
20R	20 RADIUS
NFK	NOMINAL FACE OF KERB

KERB ONLY

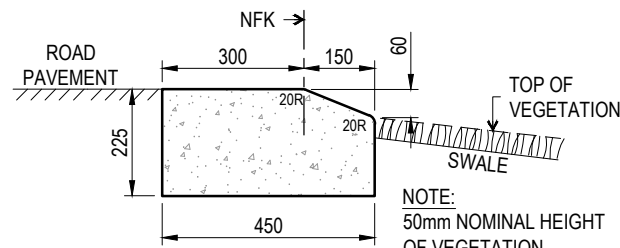

TYPE 'G'
USED FOR WATER SENSITIVE URBAN DESIGN
(WSUD) ONLY.

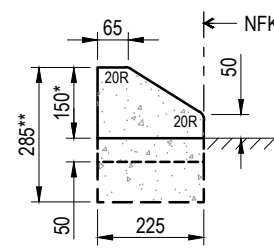

MOUNTABLE
150* DEEP PROFILE USED FOR TRAFFIC ISLANDS WITH
CONCRETE INFILL ONLY. KEY 50 DEEP INTO PAVEMENT.
285** DEEP PROFILE (AS PER BSD-2002) USED FOR
TRAFFIC ISLANDS WITH GRASS OR LANDSCAPE INFILL.

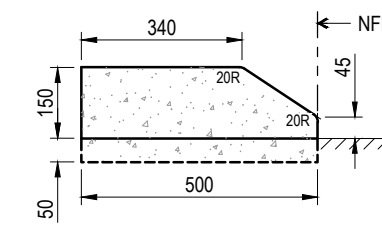

MOUNTABLE WITH BACKING STRIP
USED FOR TRAFFIC ISLANDS WITH GRASS OR
LANDSCAPING INCLUDING ROUNDABOUTS,
CHANNELISED INTERSECTIONS, TRAFFIC CONTROL
DEVICES AND ISLANDS ON DIVIDED ROADS.
KEY 50 DEEP INTO PAVEMENT.

EDGE RESTRAINTS (LANDSCAPING)

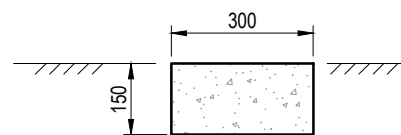

300 x 150
USED WITH NO VEHICLE LOADING.
USED AS RESTRAINT BETWEEN PAVEMENT AND/OR GRASS.
USED AS BACKING STRIP WITH TYPE 'E' AND TYPE 'D' KERB &
CHANNEL.

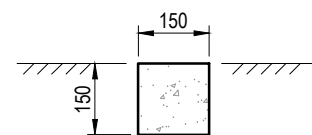

150 x 150
USED WITH NO VEHICLE LOADING.
USED AS RESTRAINT BETWEEN PAVEMENT
AND/OR GRASS.

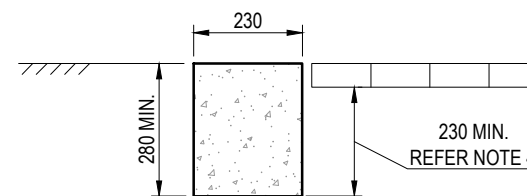

230 x 280 (MIN.)
USED FOR MAINTENANCE VEHICLE LOADING ONLY.
USED FOR RESTRAINING PAVERS FROM PAVEMENT
OR GRASS.

THE PURPOSE OF THIS STANDARD DRAWING IS TO PROVIDE TYPICAL DETAILS THAT SUPPORT THE DESIRED OUTCOMES OF THE BRISBANE CITY PLAN 2014 AND ASSOCIATED PLANNING SCHEME POLICIES. THE FITNESS FOR PURPOSE OF THIS STANDARD DRAWING FOR A SPECIFIC PROJECT SHOULD BE ASSESSED AND ACCEPTED BY AN APPROPRIATELY QUALIFIED DESIGNER AND/OR REGISTERED PROFESSIONAL ENGINEER OF QUEENSLAND (RPEQ).



BRISBANE CITY COUNCIL STANDARD DRAWING

KERB PROFILES

PUBLISH DATE	SEP 2024
SCALE	NOT TO SCALE
DRAWING NUMBER	BSD-2001
ORIGINAL SIZE	A3
REVISION	E