

**ELEVATION**

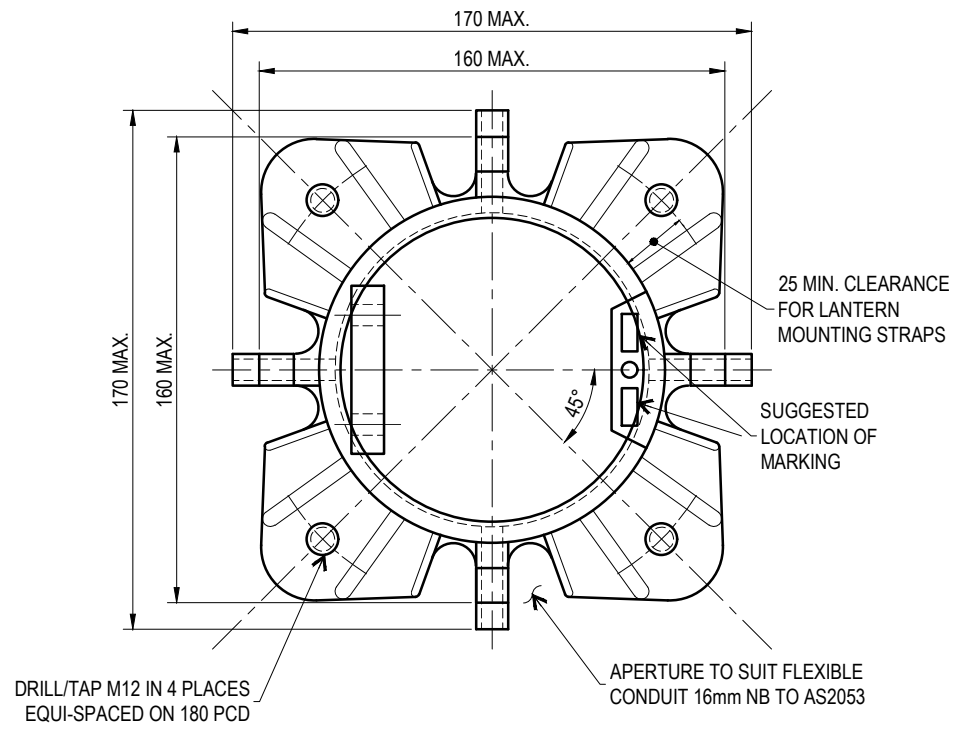

**PLAN**

(SHOWING UPPER LANTERN SUPPORT BRACKET CASTING ONLY WITH ALL OTHER PARTS DELETED FOR CLARITY)

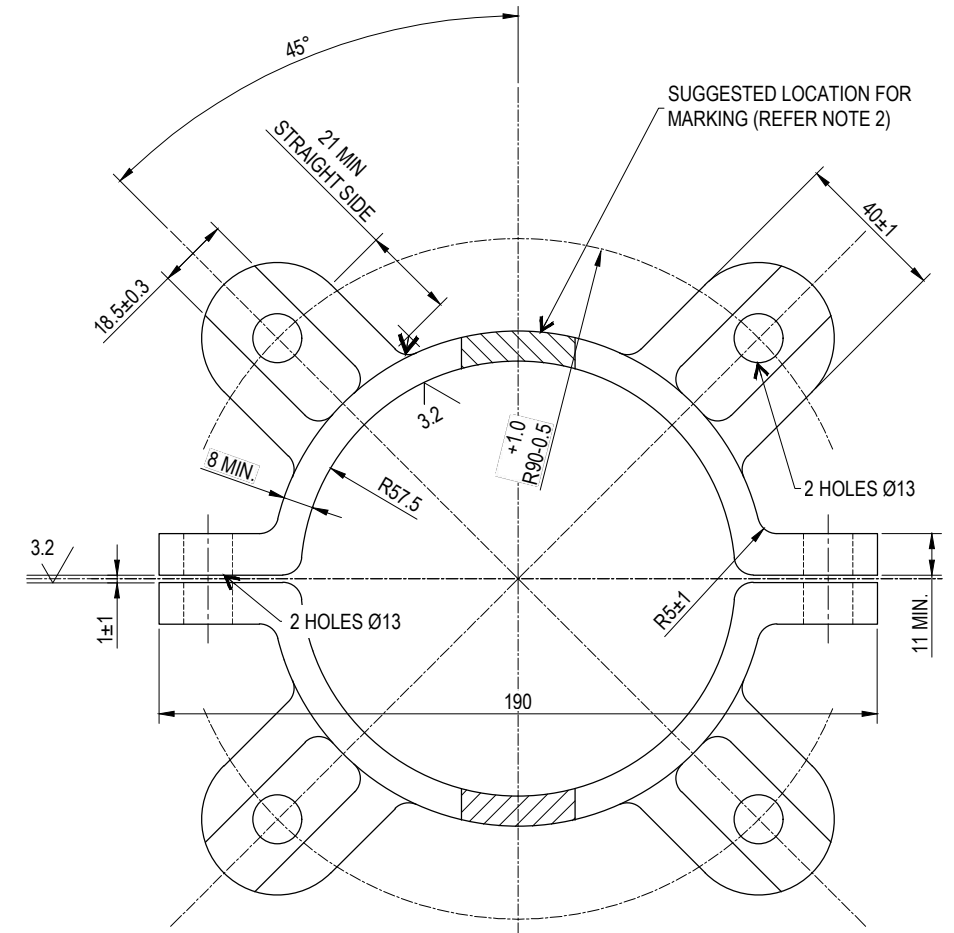

**MOUNTING BRACKET DETAIL**

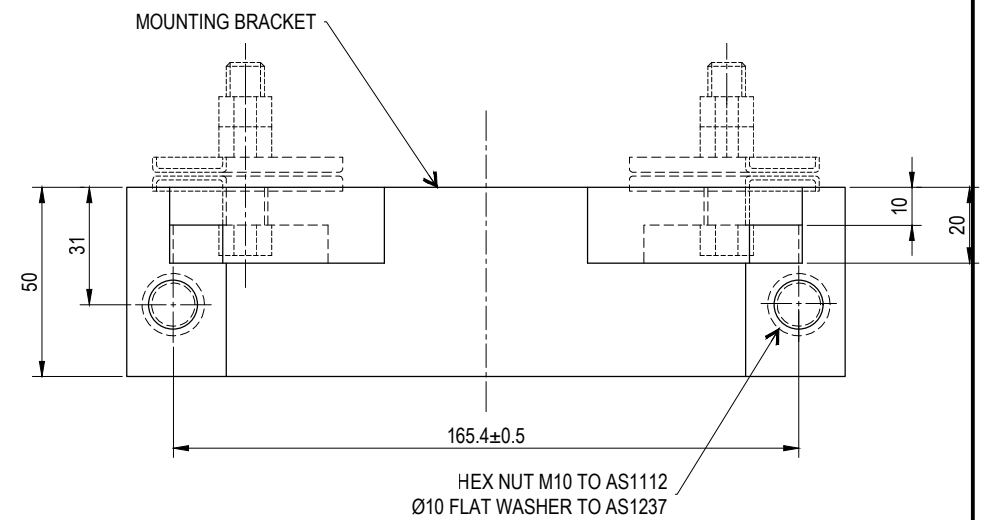

**NOTES:**

1. ALL EQUIPMENT MUST COMPLY WITH AS2339 "TRAFFIC SIGNAL POST & ATTACHMENTS".
2. MANUFACTURERS IDENTIFICATION & DATE OF MANUFACTURE SHALL BE MARKED ON THE CASTING CLEARLY, INDELIBLY AND WEATHER RESISTANT.
3. AN APPROVED ANTI-SEIZE COMPOUND CONTAINING ZINC DUST SHALL BE APPLIED TO ALL TAPPED HOLES IN THE CASTING.
4. NUMBERED TERMINALS SHALL BE ISOLATION TERMINALS.
5. FOR CABLE CONNECTIONS REFER BSD DRAWINGS LISTED IN TABLE 1 BELOW.
6. DIMENSIONS IN MILLIMETRES (U.N.O.).

CABLE SIZE	DRAWING No.
19 CORE	BSD-4203
29 CORE	BSD-4204
51 CORE	BSD-4206

THE PURPOSE OF THIS STANDARD DRAWING IS TO PROVIDE TYPICAL DETAILS THAT SUPPORT THE DESIRED OUTCOMES OF THE BRISBANE CITY PLAN 2014 AND ASSOCIATED PLANNING SCHEME POLICIES. THE FITNESS FOR PURPOSE OF THIS STANDARD DRAWING FOR A SPECIFIC PROJECT SHOULD BE ASSESSED AND ACCEPTED BY AN APPROPRIATELY QUALIFIED DESIGNER AND/OR REGISTERED PROFESSIONAL ENGINEER OF QUEENSLAND (RPEQ).



BRISBANE CITY COUNCIL STANDARD DRAWING

TRAFFIC SIGNAL POST TOP ASSEMBLY  
& LOWER MOUNTING BRACKET  
SHEET 1 OF 2

PUBLISH DATE		JUN 2023
SCALE		NOT TO SCALE
DRAWING NUMBER		BSD-4101
ORIGINAL SIZE	REVISION	
A3	C	