

PLAN
SCALE 1:20

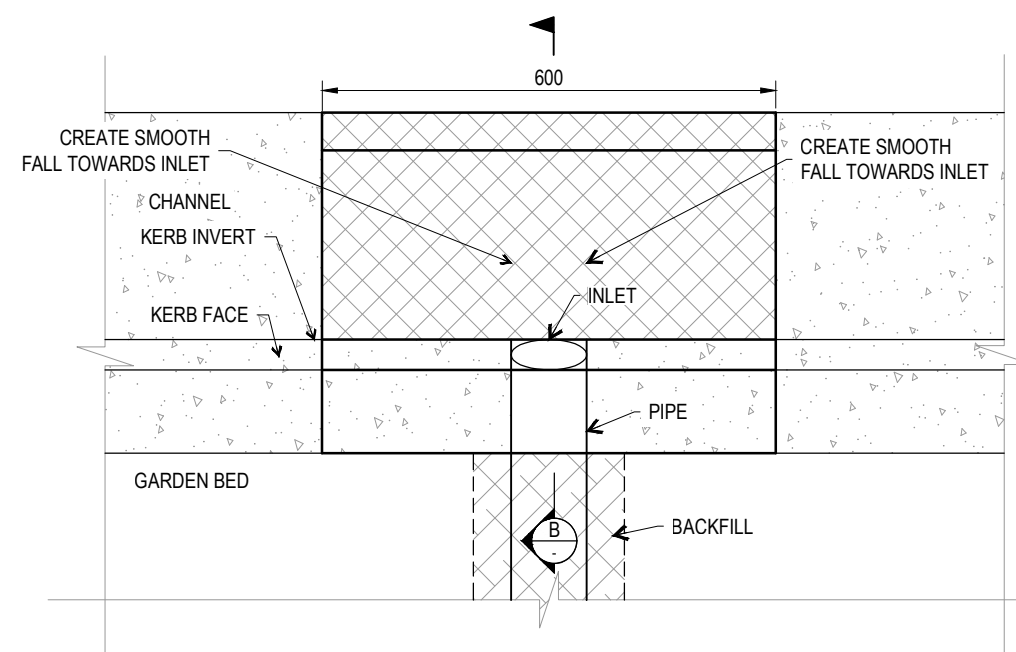

KORB INLET DETAIL 1
SCALE 1:10

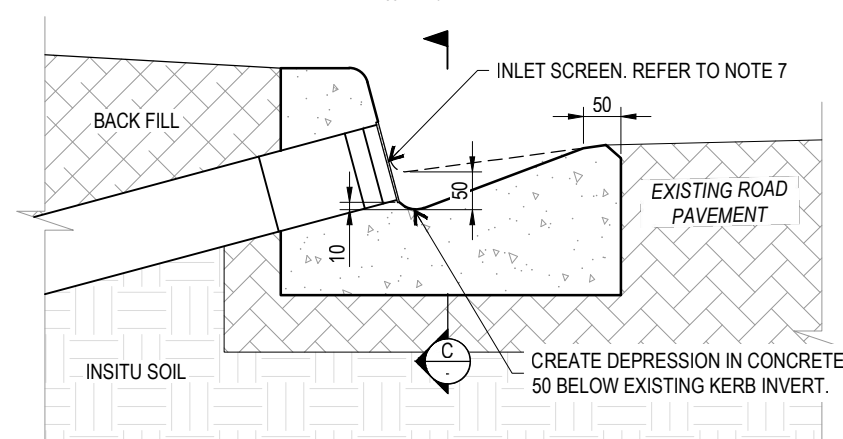

SECTION B
SCALE 1:10

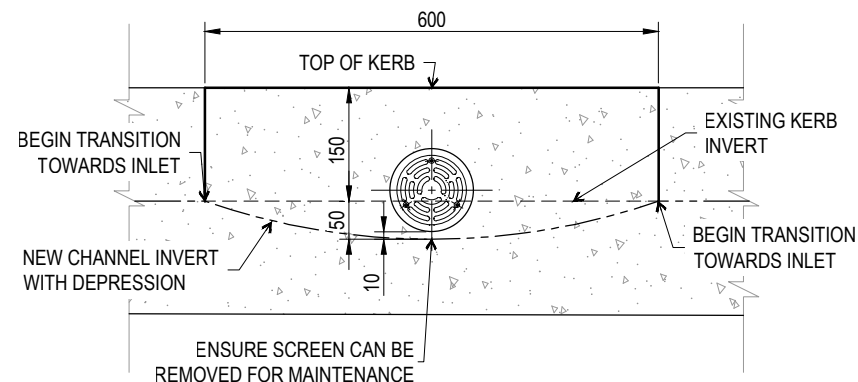

SECTION C
SCALE 1:10

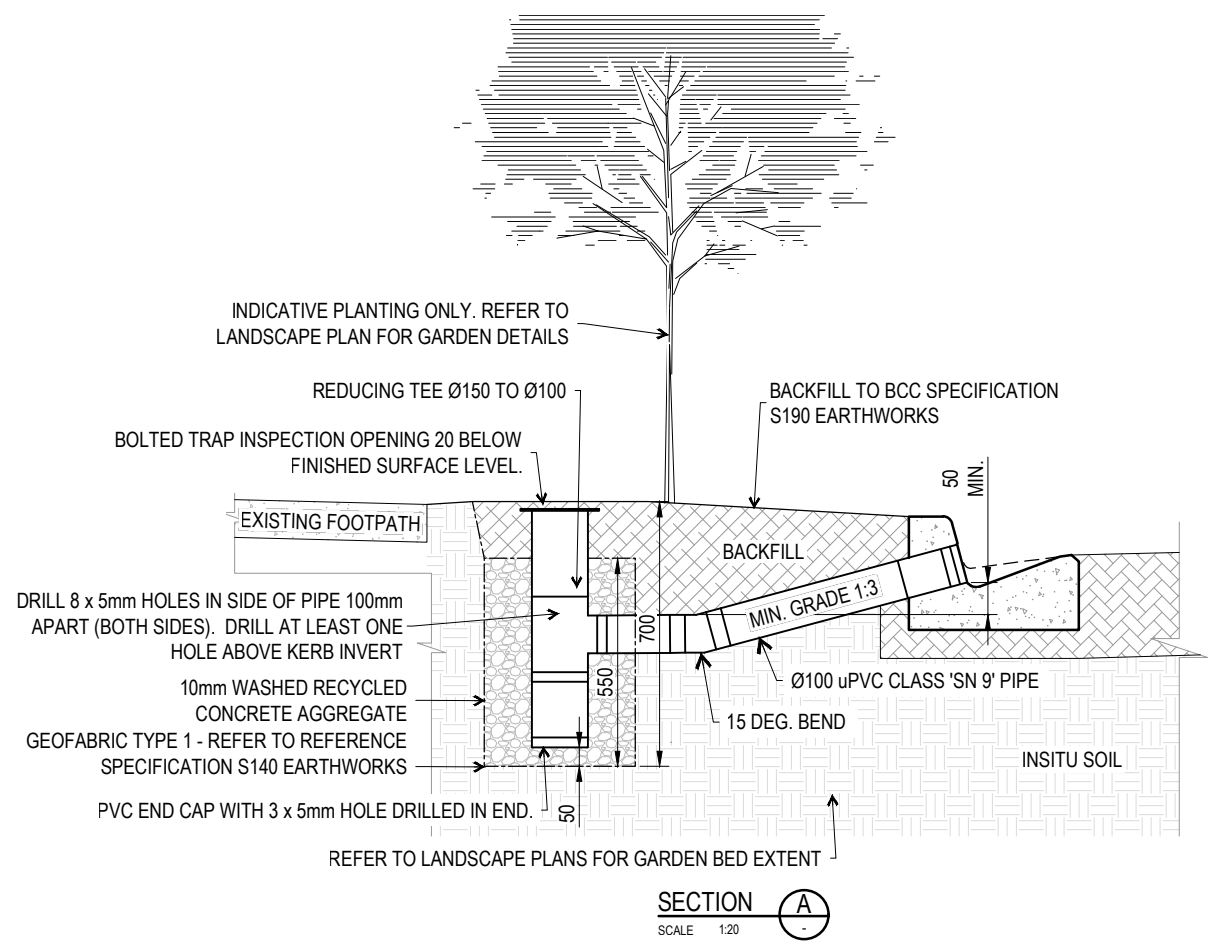

SECTION A
SCALE 1:20

NOTES:

1. THE INTENT OF THE DESIGN IS TO IMPROVE DROUGHT RESILIENCE AND TREE HEALTH BY INFILTRATING STORMWATER FROM THE KERB. THIS DESIGN IS INTENDED FOR APPLICATIONS SUCH AS INDIVIDUAL TREES OR BETWEEN TWO TREES. PLACE EVERY 3m IN GARDEN BEDS FOR PASSIVE IRRIGATION.
2. NOT INTENDED FOR STORMWATER QUALITY OR QUANTITY TREATMENT.
3. REFER TO BSD-8342 WHEN INSTALLING KERB INLET INTO EXISTING BARRIER KERB OR LAYBACK KERBS.
4. LOCATION AND VERIFICATION OF EXISTING SERVICES IS THE RESPONSIBILITY OF THE CONTRACTOR. UNDERTAKE A SERVICES SEARCH FOR LOCATIONS PRIOR TO COMMENCEMENT OF WORKS.
5. USE NON-DESTRUCTIVE DIGGING METHODS WHEN PLACING ADJACENT TO TREES.
6. WHEN INSTALLING AS A RETROFIT TO AN EXISTING TREE CONSULT AN ARBORIST FOR APPROVAL. PLACE SOAK WELL AT DRIP LINE OF EXISTING TREE, RATHER THAN MIN DISTANCE.
7. INLET SCREEN IS TO BE Ø110mm 316 STAINLESS STEEL OR SIMILAR.
8. ENSURE SCREEN CAN BE REMOVED FOR MAINTENANCE.
9. SECURE PIPES IN PLACE WITH PVC SEALANT (SIKASEAL OR SIMILAR).
10. CONCRETE FOR KERB TO BE HAND PLACED MINIMUM GRADE 32MPa.
11. REFER TO SITE-SPECIFIC LANDSCAPE PLANS AND OTHER DESIGN DRAWINGS FOR VEGETATION AND SOIL TYPES (EXCLUDED FROM THIS DRAWING). IF INSTALLING A TREE IN HIGH CLAY SOILS, SELECT A TREE THAT CAN WITHSTAND WET SOIL CONDITIONS.
12. FINISHED SURFACE LEVELS TO FOLLOW GRADE OF THE GARDEN BED OR VERGE OR AS SPECIFIED IN SITE-SPECIFIC PLANS (EXCLUDED FROM THIS DRAWING).
13. NOT SUITABLE FOR DISPERSIVE SOILS.
14. ALL WORK TO BE IN-ACCORDANCE WITH PLUMBING AND DRAINAGE AUSTRALIAN STANDARDS.
15. MINIMUM CATCHMENT AREA OF 50m² IS RECOMMENDED.
16. DIMENSIONS IN MILLIMETRES (U.N.O).

THE PURPOSE OF THIS STANDARD DRAWING IS TO PROVIDE TYPICAL DETAILS THAT SUPPORT THE DESIRED OUTCOMES OF THE BRISBANE CITY PLAN 2014 AND ASSOCIATED PLANNING SCHEME POLICIES. THE FITNESS FOR PURPOSE OF THIS STANDARD DRAWING FOR A SPECIFIC PROJECT SHOULD BE ASSESSED AND ACCEPTED BY AN APPROPRIATELY QUALIFIED DESIGNER AND/OR REGISTERED PROFESSIONAL ENGINEER OF QUEENSLAND (RPEQ).



BRISBANE CITY COUNCIL STANDARD DRAWING
STORMWATER TREATMENT ASSET (STA)
STREET TREE
PASSIVE IRRIGATION WELL

PUBLISH DATE		JUN 2023
SCALE		AS SHOWN
DRAWING NUMBER		BSD-8341
ORIGINAL SIZE	REVISION	
A3	A	