

MEMBER SCHEDULE			
MARK	MEMBER	DESCRIPTION	COMMENTS
C1	100x5 SHS	POST	
R1	100x5 SHS	RAFTER	FIXED TO POST WITH 2xM16 BOLTS. 5mm END CAPS
P1	170x45 MGP12 SEASONED TIMBER	PURLIN	FIXED TO RAFTER WITH 2x M12 BOLTS.
BR1	30x1.0 GALVANISED STEEL STRAP BRACE	STRAP BRACING TO TOP OF PURLINS	5/3.15Ø x 35mm NAILS AT EACH END OF STRAPPING FIXED TO SIDES OF PURLINS AND ONE NAIL TO TOP OF EACH PURLIN.
F1	450Øx1500 DEEP	PIER FOOTING	N25 CONCRETE.

IF OPTIONAL HORSE HITCHING RAIL IS REQUIRED, REFER TO BSD - 5003 FOR DETAILS. ENSURE HITCHING RAIL IS LOCATED ON HIGH SIDE OF SHELTER ROOF. MIN 1500mm AWAY.

CUSTOM ORB ROOFING OR APPROVED EQUAL FIXED IN ACCORDANCE TO MANUFACTURERS SPECIFICATIONS.

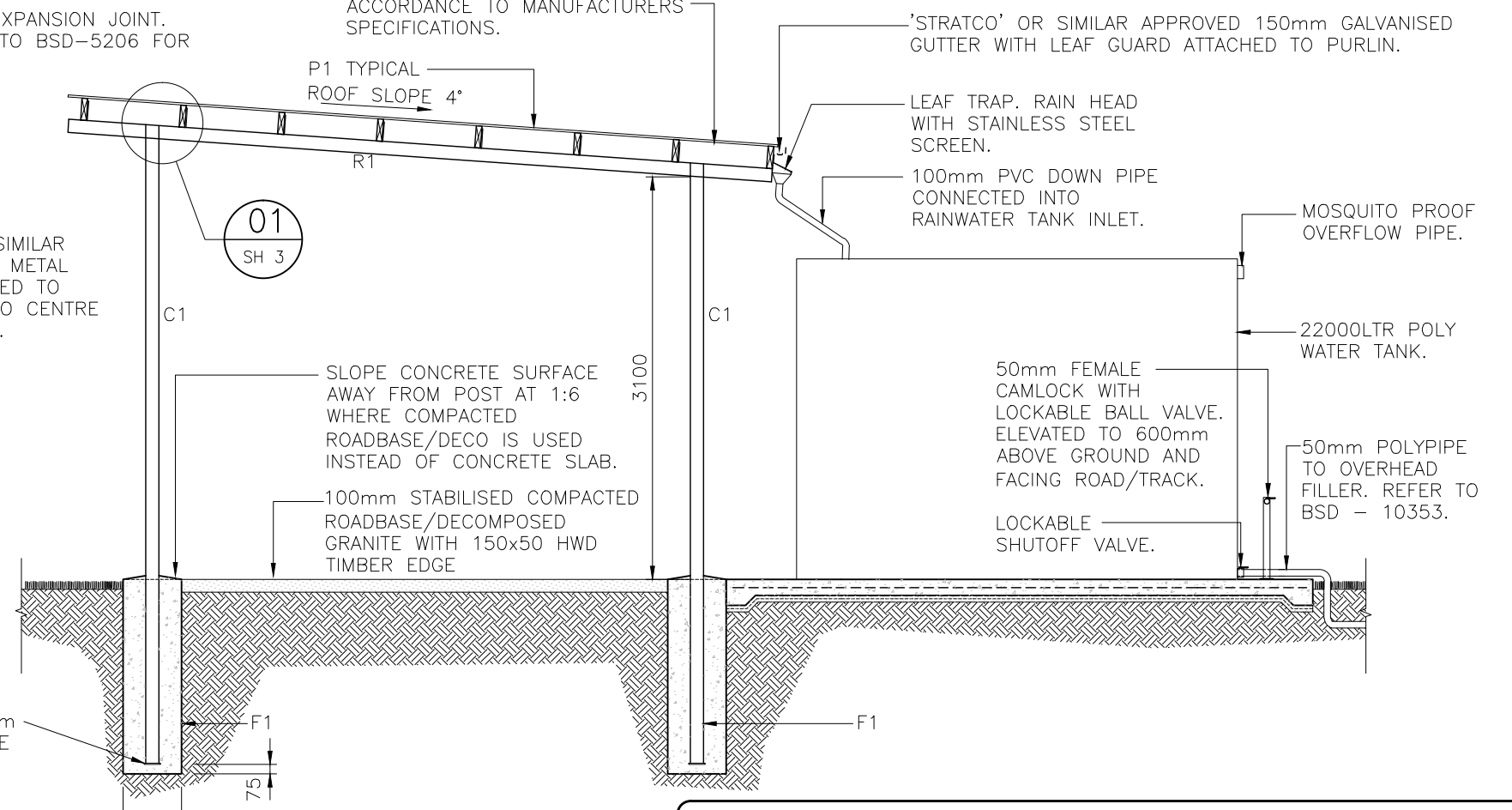
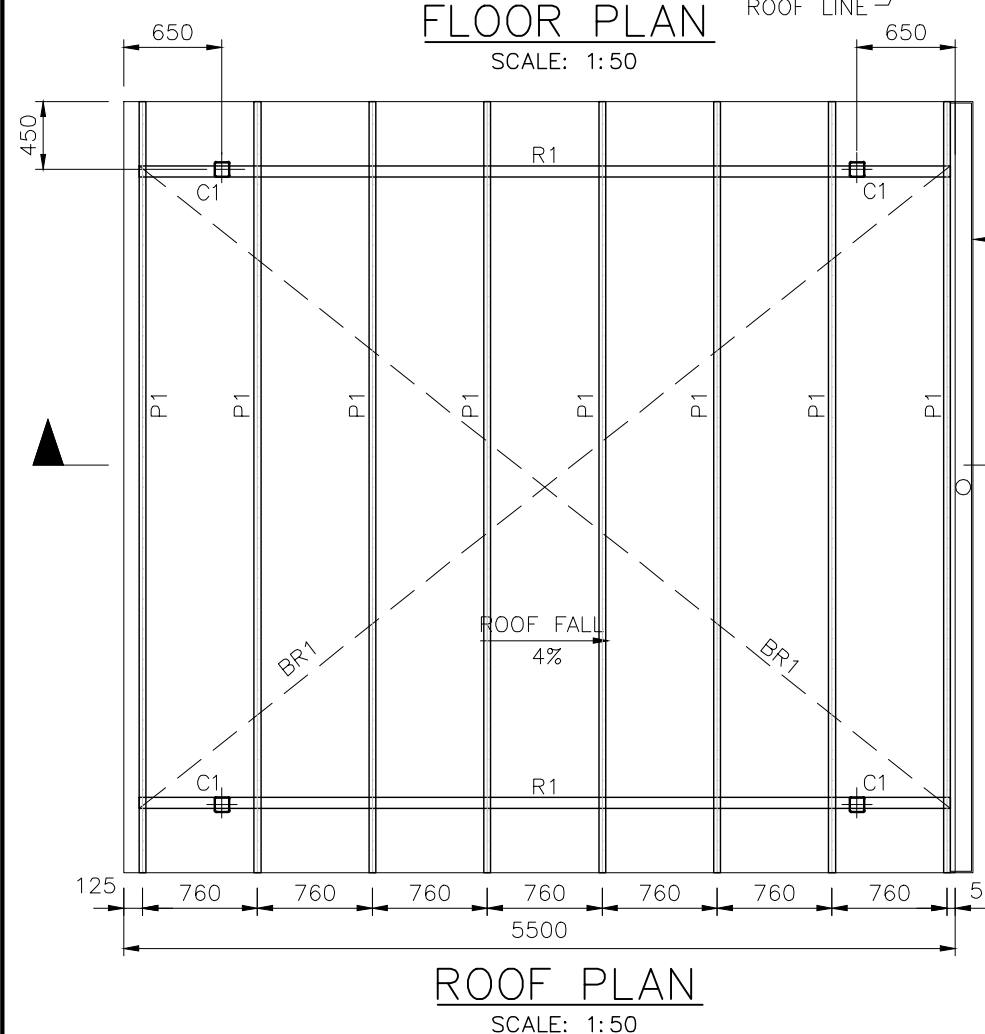

STRUCTURAL DESIGN CERTIFICATION		
DESIGN	DESIGN CHECK	AUTHORISED FOR ISSUE
Lenita Mendis RPEQ:8950 2014.12.10 16:34:35+10'00'	R.Hu (RPEQ No 13885)	Bala Balakumar RPEQ 3963 2014.12.11 09:02:44+10'00'

ISSUE	AMENDMENT	DRAWN DATE	CHK'D DATE	APPR'D DATE
B	Drawing Title Amended	FEB '16	JUL '16	JUL '16
A	ORIGINAL ISSUE	DEC '14	DEC '14	DEC '14

DRAWING AUTHORISED FOR PUBLICATION			
DESIGN	CPO - P&D	DATE	DEC '14
DRAWN	CPO - P&D	DATE	DEC '14
CHECKED	BI - FSG - AS	DATE	DEC '14
DRAWING FILENAME	BSD-10352 (B) Bushfire water supply shelter type 2 - Natural area - Plan - Sheet 2 of 3.dwg		
ASSOCIATED PLANS	BSD-10352-Sheets 1 & 3		



BRISBANE CITY COUNCIL STANDARD DRAWING

BUSHFIRE WATER SUPPLY SHELTER TYPE 2 - NATURAL AREA PLAN - SHEET 2 OF 3

SCALE AS SHOWN

DWG No. **BSD-10352**

ORIGINAL SIZE A3 REVISION B