

REAR VIEW

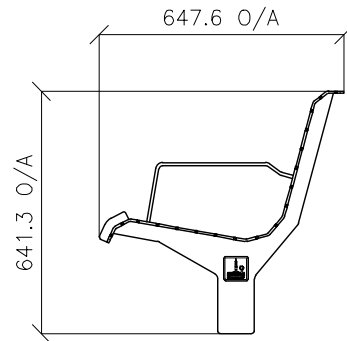

SIDE VIEW

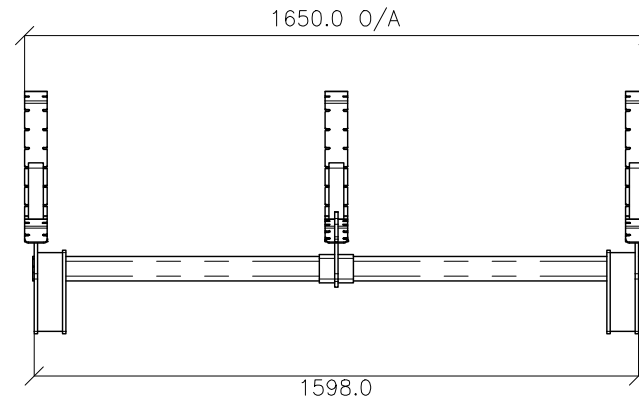

FRONT VIEW

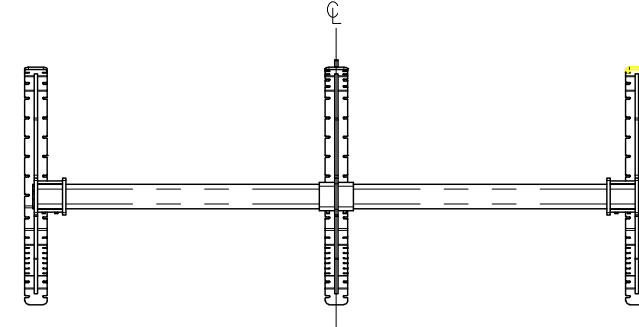

BOTTOM VIEW

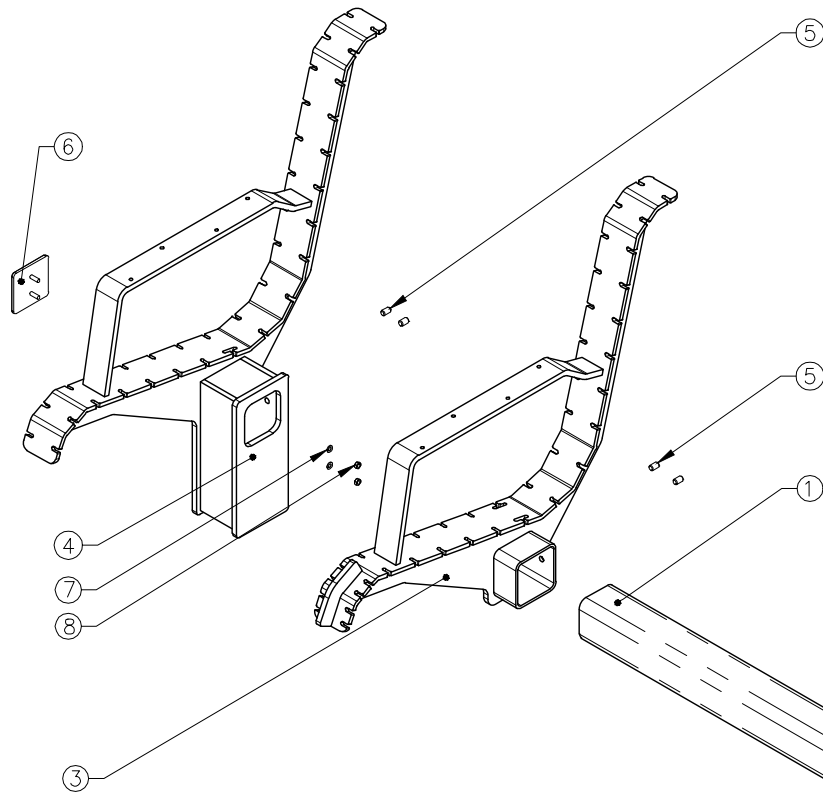

EXPLODED VIEW
SCALE 1 : 10

| ITEM NO. | DESCRIPTION | QTY. |
|----------|--|------|
| 1 | Standard Seat Rail | 1 |
| 2 | Standard Seat Outer Spine (Right) | 1 |
| 3 | Standard Seat Inner Spine | 1 |
| 4 | Standard Seat Outer Spine (Left) | 1 |
| 5 | M8 x12mm 304 Stainless Steel Grub Screw (Flat Point) | 6 |
| 6 | Standard Seat Logo Badge | 2 |
| 7 | M5 304 Stainless Steel Spring Washer | 4 |
| 8 | M5 304 Stainless Steel Nyloc Nut | 4 |

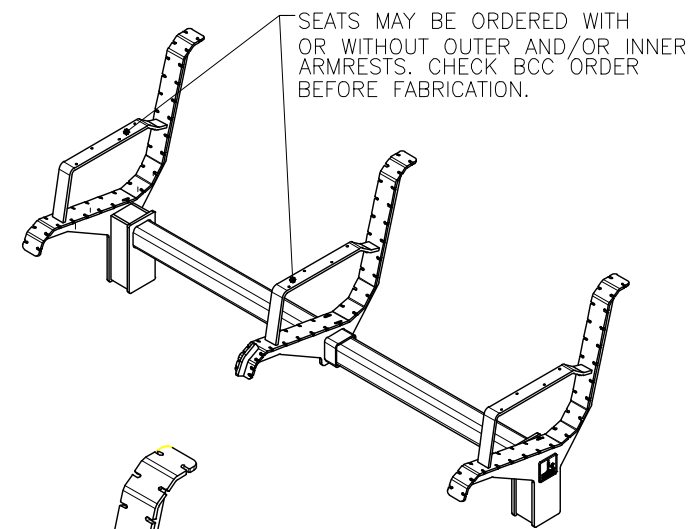

PICTORIAL VIEW

STANDARDS

DESIGNED IN ACCORDANCE WITH, AND FABRICATION TO MEET THE FOLLOWING STANDARDS:

- PARTIALLY COMPLIANT WITH AS1428.2:1992, CLAUSE 27.2 SEATING IN PEDESTRIAN AREAS.
- AS1627.4 METAL FINISHING – PREPARATION AND PRE-TREATMENT OF SURFACES – ABRASIVE BLAST CLEANING OF STEEL.
- AS2312:2002/AMDT 1:2004, GUIDE TO PROTECTION OF IRON AND STEEL AGAINST EXTERIOR ATMOSPHERIC CORROSION, 1994.
- GUIDE TO ENGINEERING PRACTICE, 'PEDESTRIANS', PART 13, AUSTRROADS.
- AS2796.3:1999, TIMBER FOR FURNITURE COMPONENTS.
- AS1604.1-2005, SPECIFICATION FOR PRESERVATIVE TREATMENT, SAWN AND ROUND TIMBER.
- AS4506 –2005, METAL FINISHING– THERMOSET POWDER COATINGS.
- AS4680:2006, HOT DIP GALVANISING.
- POWDERCOATING TO BE IN ACCORDANCE TO AS4506-2005 EXTERNAL EXPOSURE STANDARD WITH PRE-TREATMENT SAND BLAST, ZINC PHOSPHATE, ETC.
- WOOD TREATMENT – IN ACCORDANCE WITH AS1604.1 HAZARD CLASSIFICATION H3 (EXTERIOR ABOVE GROUND) AND AS2796.3 (TIMBER FOR FURNITURE COMPONENTS.)

NOTES

- WELDING TO BE ACCORDANCE TO AS1554.1 CAT GP WELDING, ALL SHARP EDGES & BURRS REMOVED.
- PART SHOULD BE SUPPLIED CLEAN AND FREE FROM MARKS, BURRS, SCUFFS, DISTORTION AND WARPAGE.
- ENSURE ANTI-SEIZE IS ON ALL NUTS AND BOLTS PRIOR TO ASSEMBLY.
- DRAWING TO AS1100 DRAWING STANDARDS.
- 316 S.S AND 316 S.S FASTENERS TO BE USED THROUGHOUT FOR COASTAL INSTALLATIONS OR ANY ENVIRONMENT WITH HIGH CORROSION.
- ALL TOLERANCES $\pm 1.5\text{mm}$ UNLESS OTHERWISE SPECIFIED.

MATERIAL

- MATERIAL: SEE COMPONENT DRAWING
- COLOUR: SEE COMPONENT DRAWING
- FINISH: SEE COMPONENT DRAWING

STRUCTURAL DESIGN REVIEWED AND CERTIFIED FOR ISSUE

NAME: B.C. PLANT RPEQ: 8807

SIGNATURE: ON ORIGINAL DATE: 28/6/12

| ISSUE | AMENDMENT | DRAWN DATE | CHK'D DATE | APPR'D DATE |
|-------|--|------------|------------|-------------|
| B | Drawing Title Amended | FEB '16 | JUL '16 | JUL '16 |
| A | Drawing Converted from UMS Series April 2014 | APR '14 | APR '14 | APR '14 |

DRAWING AUTHORISED FOR PUBLICATION
INGA CONDRIK AUTHORISED 15/04/2014

ASSET ENGINEERING MANAGER
STRATEGIC ASSET MANAGEMENT
DESIGN APPROVED

VICKI MARTIN SIGNATURE ON ORIGINAL

PRINCIPAL PLANNING OFFICER
URBAN DESIGN

| DESIGN | FORMZOO DESIGN | DATE | JUN '12 |
|------------------|--|------|---------|
| DRAWN | AB | DATE | JUN '12 |
| CHECKED | VM | DATE | APR '13 |
| DRAWING FILENAME | BSD-7201(B) Standard seat - Frame assembly - Sheet 2 of 10.dwg | | |
| ASSOCIATED PLANS | SUPERSEDES UMS-563-2 | | |



| BRISBANE CITY COUNCIL STANDARD DRAWING | |
|---|-----------------|
| STANDARD SEAT FRAME ASSEMBLY SHEET 2 OF 10 | |
| SCALE | NOT TO SCALE |
| DWG No. | BSD-7201 |
| ORIGINAL SIZE | A3 |
| REVISION | B |