

STANDARDS

DESIGNED IN ACCORDANCE WITH, AND FABRICATION TO MEET THE FOLLOWING STANDARDS:

1. COMPLIANT WITH AS1428.2:1992, CLAUSE 27.2 SEATING IN PEDESTRIAN AREAS.
2. AS1627.4 METAL FINISHING – PREPARATION AND PRE-TREATMENT OF SURFACES – ABRASIVE BLAST CLEANING OF STEEL.
3. AS2312:2002/AMDT 1:2004, GUIDE TO PROTECTION OF IRON AND STEEL AGAINST EXTERIOR ATMOSPHERIC CORROSION, 1994.
4. GUIDE TO ENGINEERING PRACTICE, 'PEDESTRIANS', PART 13, AUSTRROADS.
5. AS2796.3:1999, TIMBER FOR FURNITURE COMPONENTS.
6. AS1604.1-2005, SPECIFICATION FOR PRESERVATIVE TREATMENT, SAWN AND ROUND TIMBER.
7. AS4506 –2005, METAL FINISHING– THERMOSET POWDER COATINGS.
8. AS4680:2006, HOT DIP GALVANISING. POWDERCOATING TO BE IN ACCORDANCE TO AS4506-2005 EXTERNAL EXPOSURE STANDARD WITH PRE-TREATMENT SAND BLAST, ZINC PHOSPHATE, ETC.
9. WOOD TREATMENT – IN ACCORDANCE WITH AS1604.1 HAZARD CLASSIFICATION H3 (EXTERIOR ABOVE GROUND) AND AS2796.3 (TIMBER FOR FURNITURE COMPONENTS.)

NOTES

1. WELDING TO BE ACCORDANCE TO AS1554.1 CAT GP WELDING, ALL SHARP EDGES & BURRS REMOVED.
2. PART SHOULD BE SUPPLIED CLEAN AND FREE FROM MARKS, BURRS, SCUFFS, DISTORTION AND WARPAGE.
3. ENSURE ANTI-SEIZE IS ON ALL NUTS AND BOLTS PRIOR TO ASSEMBLY.
4. DRAWING TO AS1100 DRAWING STANDARDS.
5. 316 S.S AND 316 S.S FASTENERS TO BE USED THROUGHOUT FOR COASTAL INSTALLATIONS OR ANY ENVIRONMENT WITH HIGH CORROSION.
6. ALL TOLERANCES $\pm 1.5\text{mm}$ UNLESS OTHERWISE SPECIFIED.
7. SEAT LONG SLAT IS THE SAME PART AS BENCH LONG SLAT (REFER TO DRAWING BSD-7203)
8. SEAT SHORT SLAT IS THE SAME PART AS BENCH SHORT SLAT (REFER TO DRAWING BSD-7203)
9. SEAT ARM REST SLAT IS THE SAME PART AS BENCH ARM REST SLAT (REFER TO DRAWING BSD-7203)

MATERIAL

1. MATERIAL: HARDWOOD
2. COLOUR: JARRAH STAIN
3. FINISH: SMOOTH + WATER BASED FURNITURE OIL

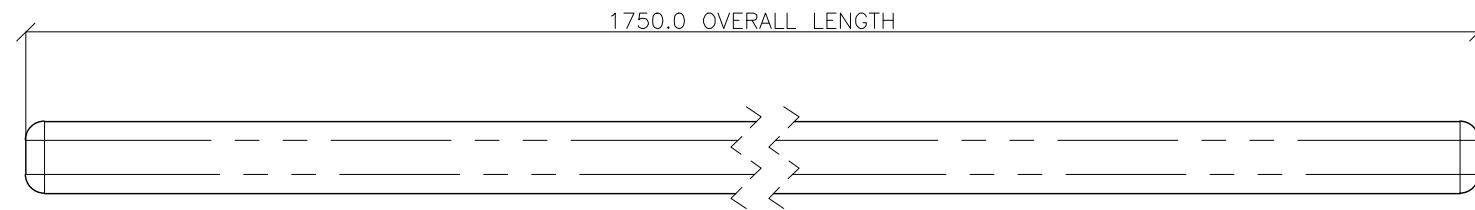

FRONT VIEW

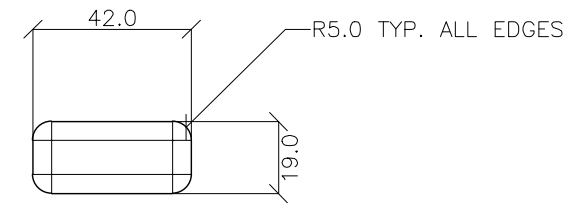

SIDE VIEW

PUBLIC TRANSPORT SEAT LONG SLAT

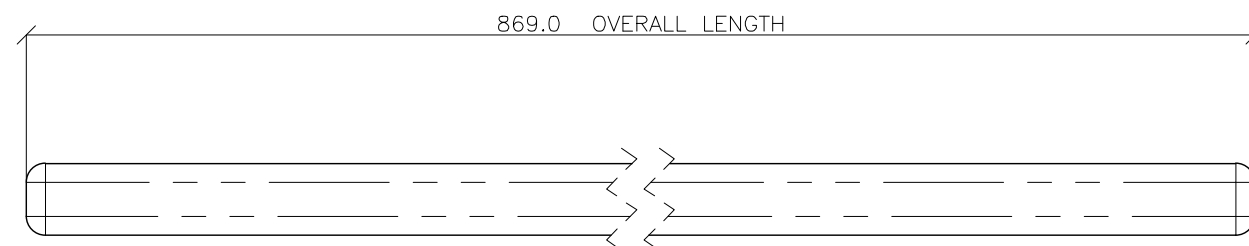

FRONT VIEW

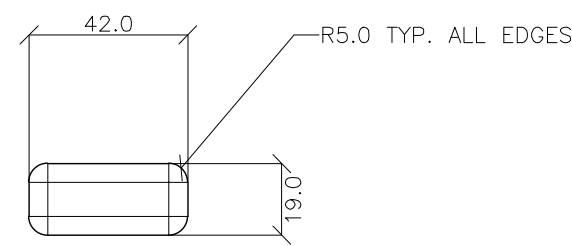

SIDE VIEW

PUBLIC TRANSPORT SEAT SHORT SLAT

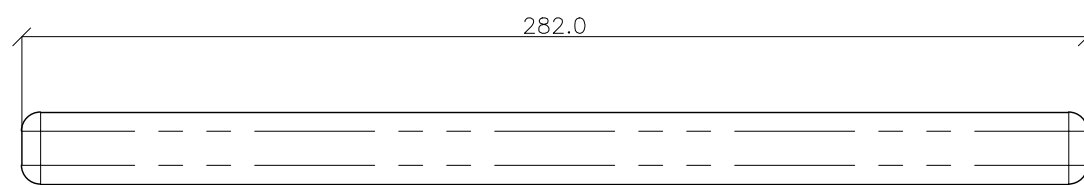

FRONT VIEW

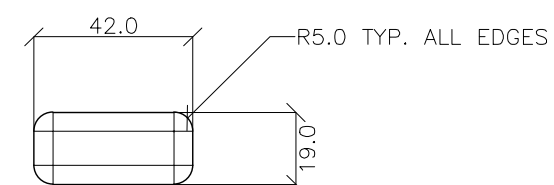

SIDE VIEW

PUBLIC TRANSPORT SEAT ARM REST SLAT

STRUCTURAL DESIGN REVIEWED AND CERTIFIED FOR ISSUE

NAME: B.C. PLANT _____ RPEQ: 8807

SIGNATURE: ON ORIGINAL _____ DATE: 28/6/12

				DRAWING AUTHORISED FOR PUBLICATION INGA CONDRIE AUTHORIZED 15/04/2014				DESIGN		FORMZOO DESIGN		DATE		JUN '12	
				ASSET ENGINEERING MANAGER STRATEGIC ASSET MANAGEMENT DESIGN APPROVED				DRAWN		AB		DATE		JUN '12	
				VICKI MARTIN SIGNATURE ON ORIGINAL				CHECKED		VM		DATE		APR '13	
				PRINCIPAL PLANNING OFFICER URBAN DESIGN				DRAWING FILENAME		BSD-7202 (8) Public transport seat - Timber slats - Sheet 8 of 10.dwg					
								ASSOCIATED PLANS		SUPERSEDES UMS-569-8					
B	Drawing Title Amended			FEB '16	JUL '16	JUL '16									
A	Drawing Converted from UMS Series April 2014			APR '14	APR '14	APR '14									
ISSUE	AMENDMENT			DRAWN DATE	CHK'D DATE	APPR'D DATE									
												BRISBANE CITY COUNCIL STANDARD DRAWING			
												PUBLIC TRANSPORT SEAT TIMBER SLATS SHEET 8 OF 10			
												SCALE: NOT TO SCALE			
												DWG No. BSD-7202			
												ORIGINAL SIZE		REVISION	
												A3		B	

