

RECOMMENDED ASSEMBLY TORQUE FOR M8 GRUB SCREWS =15N.M  
COAT WITH LOCTITE 243 THREADLOCKER PRIOR TO INSERTION.

REAR VIEW

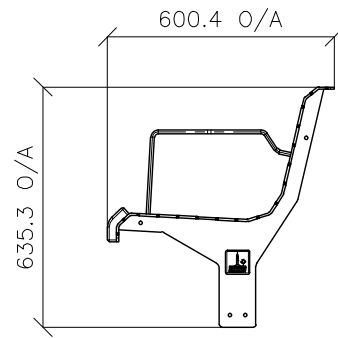

SIDE VIEW

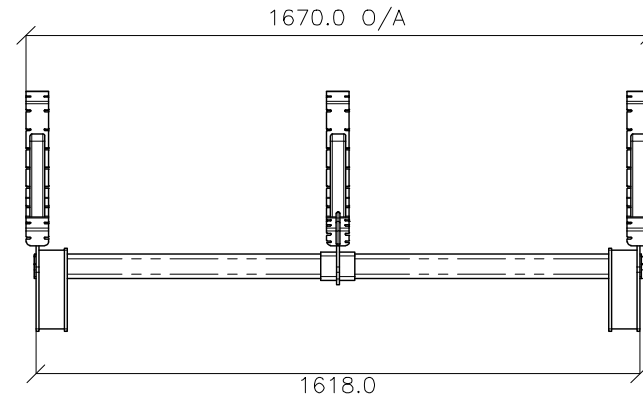

FRONT VIEW

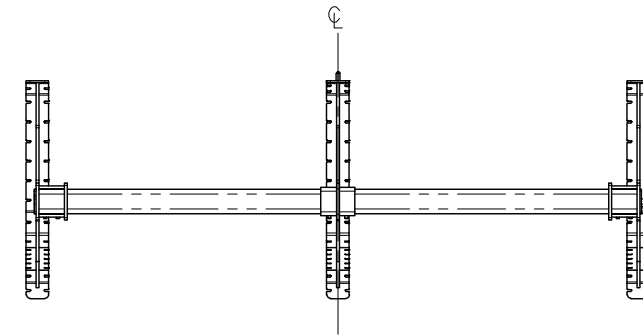

BOTTOM VIEW

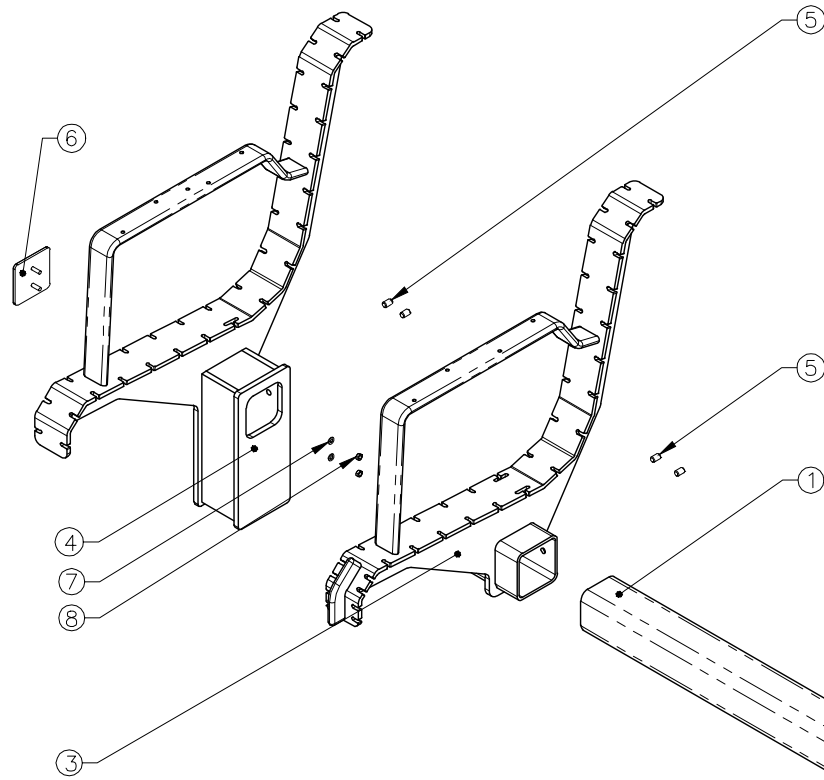

EXPLODED VIEW  
SCALE 1 : 10

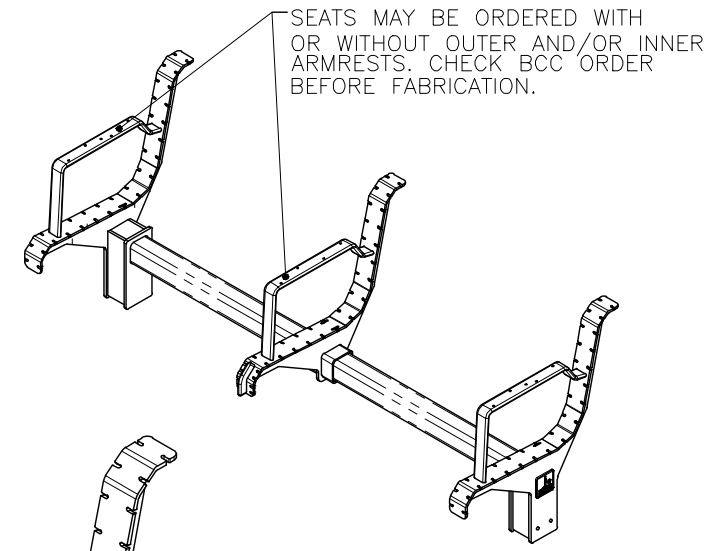

PICTORIAL VIEW

## STANDARDS

DESIGNED IN ACCORDANCE WITH, AND FABRICATION TO MEET THE FOLLOWING STANDARDS:

1. COMPLIANT WITH AS1428.2:1992, CLAUSE 27.2 SEATING IN PEDESTRIAN AREAS.
2. AS1627.4 METAL FINISHING - PREPARATION AND PRE-TREATMENT OF SURFACES - ABRASIVE BLAST CLEANING OF STEEL.
3. AS2312:2002/AMDT 1:2004, GUIDE TO PROTECTION OF IRON AND STEEL AGAINST EXTERIOR ATMOSPHERIC CORROSION, 1994.
4. GUIDE TO ENGINEERING PRACTICE, 'PEDESTRIANS', PART 13, AUSTRROADS.
5. AS2796.3:1999, TIMBER FOR FURNITURE COMPONENTS.
6. AS1604.1-2005, SPECIFICATION FOR PRESERVATIVE TREATMENT, SAWN AND ROUND TIMBER.
7. AS4506 -2005, METAL FINISHING- THERMOSET POWDER COATINGS.
8. AS4680:2006, HOT DIP GALVANISING.
9. POWDERCOATING TO BE IN ACCORDANCE TO AS4506-2005 EXTERNAL EXPOSURE STANDARD WITH PRE-TREATMENT SAND BLAST, ZINC PHOSPHATE, ETC.
10. WOOD TREATMENT - IN ACCORDANCE WITH AS1604.1 HAZARD CLASSIFICATION H3 (EXTERIOR ABOVE GROUND) AND AS2796.3 (TIMBER FOR FURNITURE COMPONENTS.)

## NOTES

1. WELDING TO BE ACCORDANCE TO AS1554.1 CAT GP WELDING, ALL SHARP EDGES & BURRS REMOVED.
2. PART SHOULD BE SUPPLIED CLEAN AND FREE FROM MARKS, BURRS, SCUFFS, DISTORTION AND WARPAGE.
3. ENSURE ANTI-SEIZE IS ON ALL NUTS AND BOLTS PRIOR TO ASSEMBLY.
4. DRAWING TO AS1100 DRAWING STANDARDS.
5. 316 S.S AND 316 S.S FASTENERS TO BE USED THROUGHOUT FOR COASTAL INSTALLATIONS OR ANY ENVIRONMENT WITH HIGH CORROSION.
6. ALL TOLERANCES  $\pm 1.5\text{mm}$  UNLESS OTHERWISE SPECIFIED.

## MATERIAL

1. MATERIAL: SEE COMPONENT DRAWING
2. COLOUR: SEE COMPONENT DRAWING
3. FINISH: SEE COMPONENT DRAWING

ITEM NO.	DESCRIPTION	QTY.
1	Public Transport Seat Rail	1
2	Public Transport Seat Outer Spine (Right)	1
3	Public Transport Seat Inner Spine	1
4	Public Transport Seat Outer Spine (Left)	1
5	M8 x12mm 304 Stainless Steel Grub Screw (Flat Point)	6
6	Public Transport Seat Logo Badge	2
7	M5 304 Stainless Steel Spring Washer	4
8	M5 304 Stainless Steel Nyloc Nut	4

STRUCTURAL DESIGN REVIEWED AND CERTIFIED FOR ISSUE

NAME: B.C. PLANT RPEQ: 8807

SIGNATURE: ON ORIGINAL DATE: 28/ 6 /12

ISSUE	AMENDMENT	DRAWN DATE	CHK'D DATE	APPR'D DATE
C	Drawing Title Amended	FEB '16	JUL '16	JUL '16
B	Advertising panel amendments	SEPT '14	SEPT '14	SEPT '14
A	ORIGINAL ISSUE	OCT '13	OCT '13	OCT '13

DRAWING AUTHORISED FOR PUBLICATION  
INGA CONDRC AUTHORIZED 15/04/2014

ASSET ENGINEERING MANAGER  
STRATEGIC ASSET MANAGEMENT  
DESIGN APPROVED

VICKI MARTIN SIGNATURE ON ORIGINAL

PRINCIPAL PLANNING OFFICER  
URBAN DESIGN

DESIGN	FORMZOO DESIGN	DATE	JUN '12
DRAWN	AB	DATE	JUN '12
CHECKED	VM	DATE	APR '13
DRAWING FILENAME	BSD-7202 (C) Public transport seat - Frame assembly - Sheet 2 of 10.dwg		
ASSOCIATED PLANS	SUPERSEDES UMS-569-2		



BRISBANE CITY COUNCIL STANDARD DRAWING	
PUBLIC TRANSPORT SEAT FRAME ASSEMBLY SHEET 2 OF 10	
SCALE: NOT TO SCALE	DWG No. <b>BSD-7202</b>
ORIGINAL SIZE: A3	REVISION: C