

ITEM NO.	DESCRIPTION	QTY.
1	Bench Rail	1
2	Bench Outer Spine (Right)	1
3	Bench Inner Spine	1
4	Bench Outer Spine (Left)	1
5	M8 x12mm 304 Stainless Steel Grub Screw (Flat Point)	6
6	Bench Logo Badge	2
7	M5 304 Stainless Steel Spring Washer	4
8	M5 304 Stainless Steel Nyloc Nut	4

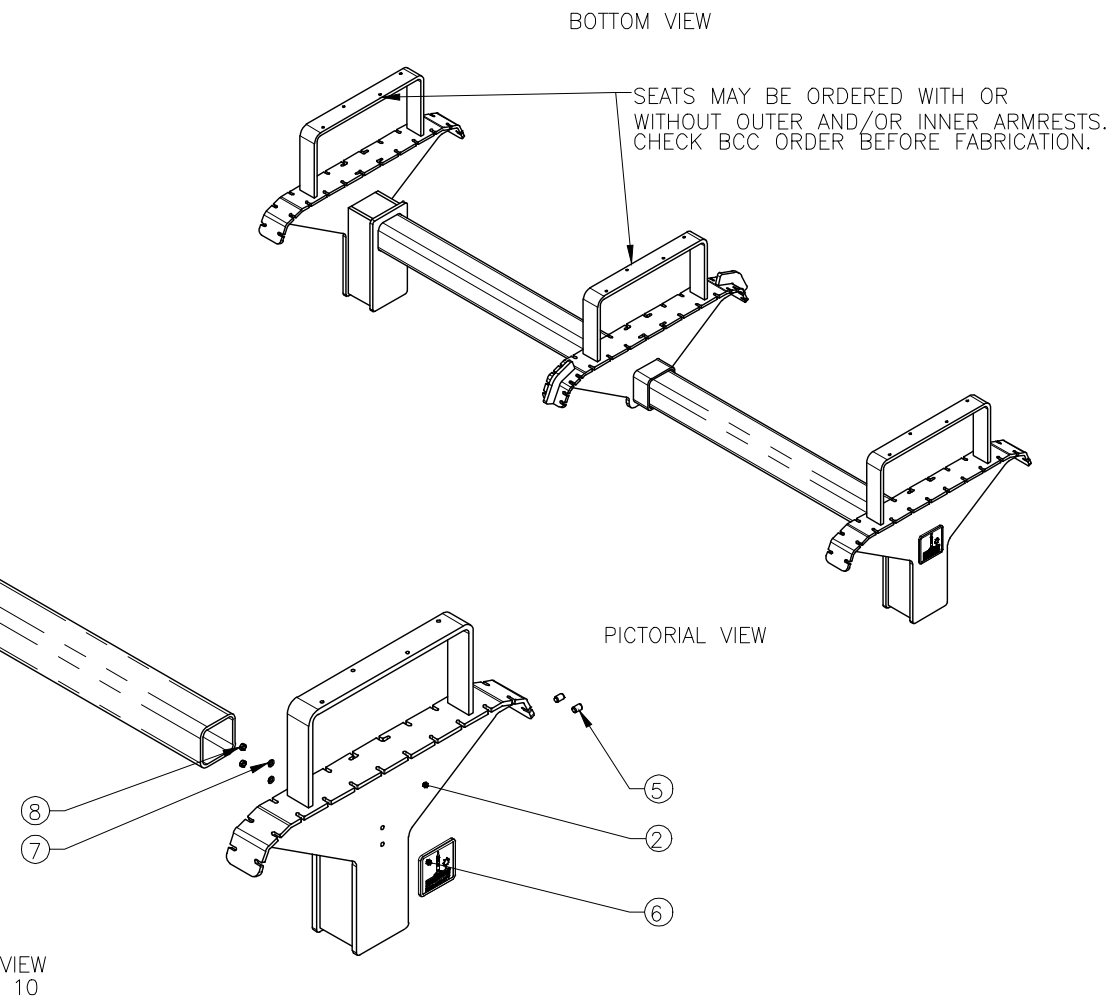

EXPLODED VIEW  
SCALE 1 : 10

### STANDARDS

- DESIGNED IN ACCORDANCE WITH, AND FABRICATION TO MEET THE FOLLOWING STANDARDS:
- AS1627.4 METAL FINISHING – PREPARATION AND PRE-TREATMENT OF SURFACES – ABRASIVE BLAST CLEANING OF STEEL.
  - AS2312:2002/AMDT 1:2004, GUIDE TO PROTECTION OF IRON AND STEEL AGAINST EXTERIOR ATMOSPHERIC CORROSION, 1994.
  - GUIDE TO ENGINEERING PRACTICE, 'PEDESTRIANS', PART 13, AUSTRROADS.
  - AS2796.3:1999, TIMBER FOR FURNITURE COMPONENTS.
  - AS1604.1–2005, SPECIFICATION FOR PRESERVATIVE TREATMENT, SAWN AND ROUND TIMBER.
  - AS4506 –2005, METAL FINISHING– THERMOSET POWDER COATINGS.
  - AS4680:2006, HOT DIP GALVANISING.
  - POWDERCOATING TO BE IN ACCORDANCE TO AS4506–2005 EXTERNAL EXPOSURE STANDARD WITH PRE-TREATMENT SAND BLAST, ZINC PHOSPHATE, ETC.
  - WOOD TREATMENT – IN ACCORDANCE WITH AS1604.1 HAZARD CLASSIFICATION H3 (EXTERIOR ABOVE GROUND) AND AS2796.3 (TIMBER FOR FURNITURE COMPONENTS.)

### NOTES

- WELDING TO BE ACCORDANCE TO AS1554.1 CAT GP WELDING, ALL SHARP EDGES & BURRS REMOVED.
- PART SHOULD BE SUPPLIED CLEAN AND FREE FROM MARKS, BURRS, SCUFFS, DISTORTION AND WARPAGE.
- ENSURE ANTI-SEIZE IS ON ALL NUTS AND BOLTS PRIOR TO ASSEMBLY.
- DRAWING TO AS1100 DRAWING STANDARDS.
- 316 S.S AND 316 S.S FASTENERS TO BE USED THROUGHOUT FOR COASTAL INSTALLATIONS OR ANY ENVIRONMENT WITH HIGH CORROSION.
- ALL TOLERANCES ± 1.5mm UNLESS OTHERWISE SPECIFIED.

### MATERIAL

- MATERIAL: SEE COMPONENT DRAWING
- COLOUR: SEE COMPONENT DRAWING
- FINISH: SEE COMPONENT DRAWING

**STRUCTURAL DESIGN REVIEWED AND CERTIFIED FOR ISSUE**

NAME: B.C. PLANT RPEQ: 8807  
SIGNATURE: ON ORIGINAL DATE: 28/6/12

DRAWING AUTHORISED FOR PUBLICATION INGA CONDRIK AUTHORISED 15/04/2014				DESIGN	FORMZOO DESIGN	DATE	JUN '12
ASSET ENGINEERING MANAGER STRATEGIC ASSET MANAGEMENT DESIGN APPROVED				DRAWN	AB	DATE	JUN '12
VICKI MARTIN SIGNATURE ON ORIGINAL				CHECKED	VM	DATE	APR '13
PRINCIPAL PLANNING OFFICER URBAN DESIGN				DRAWING FILENAME	BSD-7203 (B) Bench - Frame assembly - Sheet 2 of 10.dwg		
				ASSOCIATED PLANS	SUPERSEDES UMS-564-2		



**BRISBANE CITY COUNCIL STANDARD DRAWING**

**BENCH FRAME ASSEMBLY SHEET 2 OF 10**

SCALE NOT TO SCALE	
DWG No. <b>BSD-7203</b>	
ORIGINAL SIZE A3	REVISION B

ISSUE	AMENDMENT	DRAWN DATE	CHK'D DATE	APPR'D DATE
B	Drawing Title Amended	FEB '16	JUL '16	JUL '16
A	Drawing Converted from UMS Series April 2014	APR '14	APR '14	APR '14