

FRONT VIEW

BENCH LONG SLAT

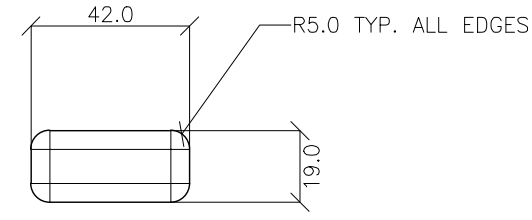

SIDE VIEW

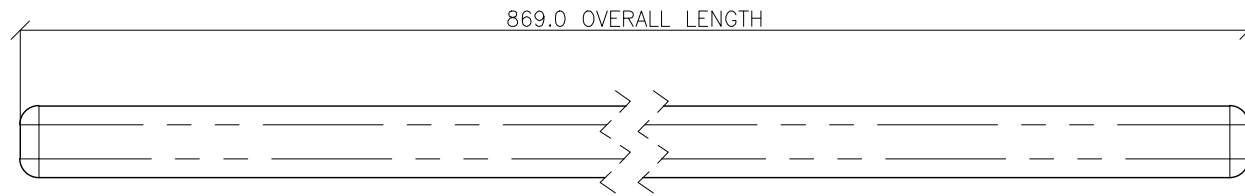

FRONT VIEW

BENCH SHORT SLAT

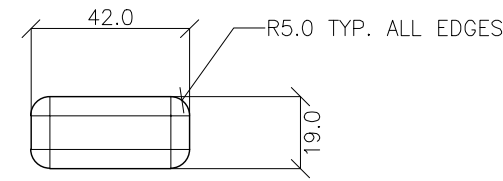

SIDE VIEW

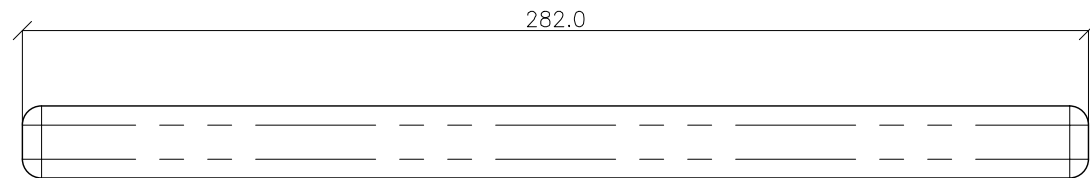

FRONT VIEW

BENCH ARM REST SLAT

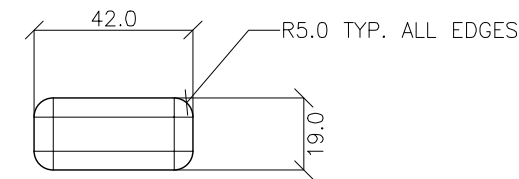

SIDE VIEW

STANDARDS

DESIGNED IN ACCORDANCE WITH, AND FABRICATION TO MEET THE FOLLOWING STANDARDS:

- AS1627.4 METAL FINISHING – PREPARATION AND PRE-TREATMENT OF SURFACES – ABRASIVE BLAST CLEANING OF STEEL.
- AS2312:2002/AMDT 1:2004, GUIDE TO PROTECTION OF IRON AND STEEL AGAINST EXTERIOR ATMOSPHERIC CORROSION, 1994.
- GUIDE TO ENGINEERING PRACTICE, 'PEDESTRIANS', PART 13, AUSTRROADS.
- AS2796.3:1999, TIMBER FOR FURNITURE COMPONENTS.
- AS1604.1–2005, SPECIFICATION FOR PRESERVATIVE TREATMENT, SAWN AND ROUND TIMBER.
- AS4506 –2005, METAL FINISHING– THERMOSET POWDER COATINGS.
- AS4680:2006, HOT DIP GALVANISING.
- POWDERCOATING TO BE IN ACCORDANCE TO AS4506–2005 EXTERNAL EXPOSURE STANDARD WITH PRE-TREATMENT SAND BLAST, ZINC PHOSPHATE, ETC.
- WOOD TREATMENT – IN ACCORDANCE WITH AS1604.1 HAZARD CLASSIFICATION H3 (EXTERIOR ABOVE GROUND) AND AS2796.3 (TIMBER FOR FURNITURE COMPONENTS.)

NOTES

- WELDING TO BE ACCORDANCE TO AS1554.1 CAT GP WELDING, ALL SHARP EDGES & BURRS REMOVED.
- PART SHOULD BE SUPPLIED CLEAN AND FREE FROM MARKS, BURRS, SCUFFS, DISTORTION AND WARPAGE.
- ENSURE ANTI-SEIZE IS ON ALL NUTS AND BOLTS PRIOR TO ASSEMBLY.
- DRAWING TO AS1100 DRAWING STANDARDS.
- 316 S.S AND 316 S.S FASTENERS TO BE USED THROUGHOUT FOR COASTAL INSTALLATIONS OR ANY ENVIRONMENT WITH HIGH CORROSION.
- ALL TOLERANCES $\pm 1.5\text{mm}$ UNLESS OTHERWISE SPECIFIED.
- BENCH LONG SLAT IS THE SAME PART AS SEAT LONG SLAT (REFER TO DRAWING BSD-7201 & BSD-7202)
- BENCH SHORT SLAT IS THE SAME PART AS SEAT SHORT SLAT (REFER TO DRAWING BSD-7201 & BSD-7202)
- BENCH ARM REST SLAT IS THE SAME PART AS SEAT ARM REST SLAT (REFER TO DRAWING BSD-7201 & BSD-7202)

MATERIAL

- MATERIAL: HARDWOOD
- COLOUR: JARRAH STAIN
- FINISH: SMOOTH + WATER BASED FURNITURE OIL

STRUCTURAL DESIGN REVIEWED AND CERTIFIED FOR ISSUE

NAME: B.C. PLANT _____ RPEQ: 8807

SIGNATURE: ON ORIGINAL _____ DATE: 28/ 6 / 12

ISSUE	AMENDMENT	DRAWN DATE	CHK'D DATE	APPR'D DATE
B	Drawing Title Amended	FEB '16	JUL '16	JUL '16
A	Drawing Converted from UMS Series April 2014	APR '14	APR '14	APR '14

DRAWING AUTHORISED FOR PUBLICATION INGA CONDRIE AUTHORISED 15/04/2014			
DESIGN	FORMZOO DESIGN	DATE	JUN '12
DRAWN	AB	DATE	JUN '12
CHECKED	VM	DATE	APR '13
ASSET ENGINEERING MANAGER STRATEGIC ASSET MANAGEMENT DESIGN APPROVED			
VICKI MARTIN SIGNATURE ON ORIGINAL			
PRINCIPAL PLANNING OFFICER URBAN DESIGN			
DRAWING FILENAME	BSD-7203 (B) Bench - Timber slats - Sheet 8 of 10.dwg		
ASSOCIATED PLANS	SUPERSEDES UMS-564-8		

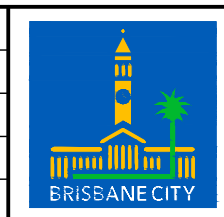

BRISBANE CITY COUNCIL STANDARD DRAWING	
BENCH TIMBER SLATS SHEET 8 OF 10	
SCALE	NOT TO SCALE
DWG No.	BSD-7203
ORIGINAL SIZE	A3
REVISION	B