

**CONCRETE FOOTPATH - DECORATIVE
SAWCUT PATTERN A**

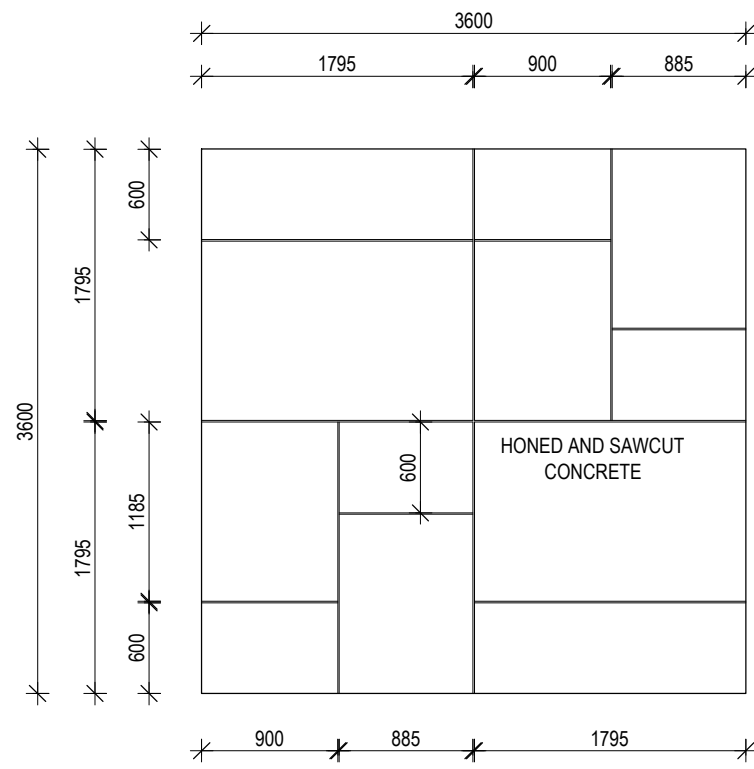

**CONCRETE FOOTPATH - DECORATIVE
SAWCUT PATTERN B**

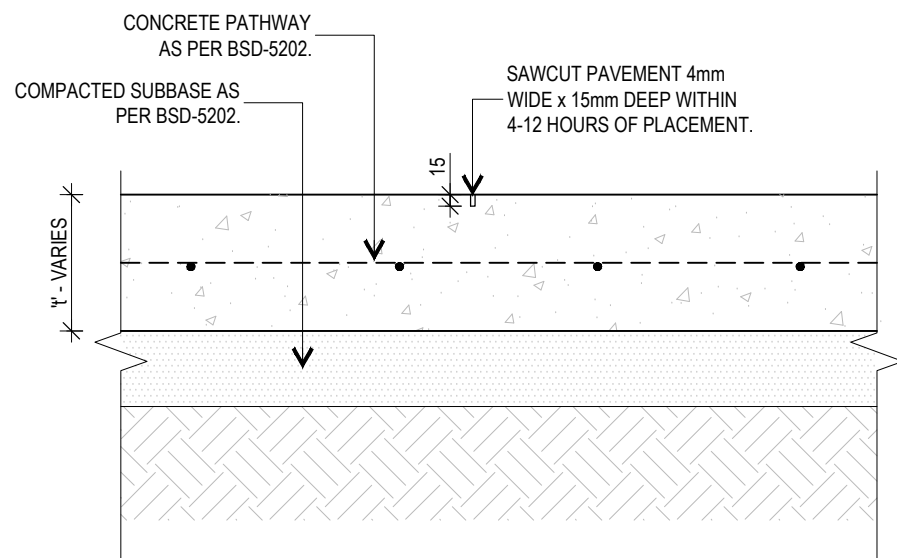

**CONCRETE FOOTPATH - DECORATIVE
SAWCUT SECTION**

GENERAL NOTES:

1. REFER TO BSD-5202 AND REFERENCE SPECIFICATION FOR ENGINEERING WORKS S205 CENTRES HONED CONCRETE PATHS FOR CONCRETE PATHWAY DETAILS AND SPECIFICATIONS. REFER TO BSD-5206 FOR JOINTING DETAILS.
CJ - CONSTRUCTION JOINT
EJ - EXPANSION JOINT
IJ - ISOLATION JOINT
2. FOR HONING OF CONCRETE REFER TO BSD-5202 CONCRETE FINISHES SPECIFICATIONS.
3. ALL DIMENSIONS IN MILLIMETRES (U.N.O.).
4. REFER TO CHAPTER 5 OF THE INFRASTRUCTURE DESIGN PLANNING SCHEME POLICY FOR LOCATIONS ON WHERE HONED AND SAWCUT PAVEMENT TREATMENT IS TO BE APPLIED.
5. WHERE ADJOINING AN EXISTING FOOTPATH WITH MATCHING PAVEMENT TREATMENT ENSURE SAWCUTS AND PATTERNS ALIGN.
6. TOLERANCES FOR SAWCUTTING ARE ± 5 mm.

ISOLATION JOINT ALONG LENGTH OF KERB. REFER TO BSD-5210 FOR ISOLATION JOINT DETAILS.

STANDARD KERB AND CHANNEL. REFER TO BSD-2001.

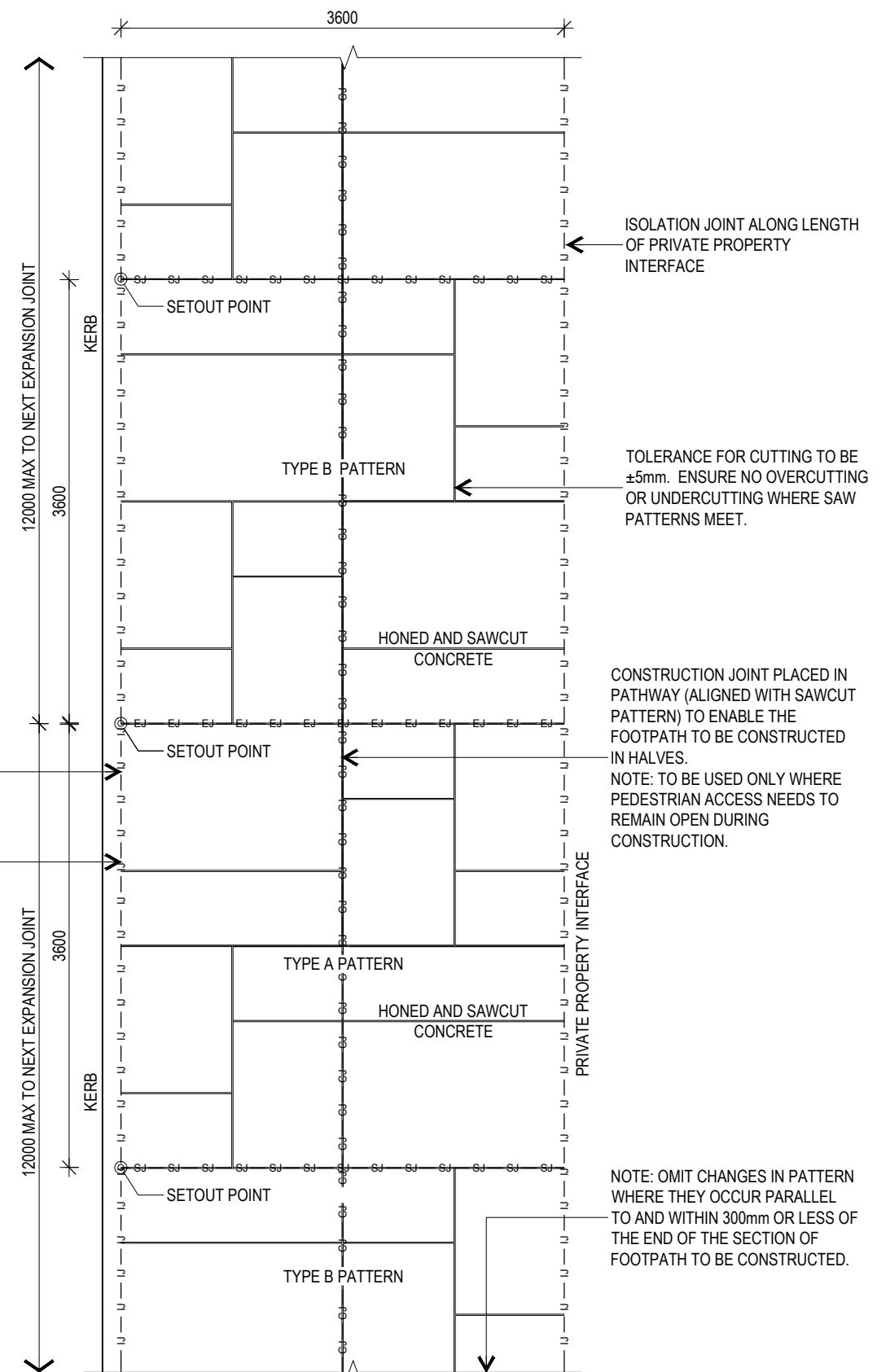

CONCRETE FOOTPATH-JOINT SETOUT

ISOLATION JOINT ALONG LENGTH OF PRIVATE PROPERTY INTERFACE

TOLERANCE FOR CUTTING TO BE ± 5 mm. ENSURE NO OVERCUTTING OR UNDERCUTTING WHERE SAW PATTERNS MEET.

CONSTRUCTION JOINT PLACED IN PATHWAY (ALIGNED WITH SAWCUT PATTERN) TO ENABLE THE FOOTPATH TO BE CONSTRUCTED IN HALVES.
NOTE: TO BE USED ONLY WHERE PEDESTRIAN ACCESS NEEDS TO REMAIN OPEN DURING CONSTRUCTION.

NOTE: OMIT CHANGES IN PATTERN WHERE THEY OCCUR PARALLEL TO AND WITHIN 300mm OR LESS OF THE END OF THE SECTION OF FOOTPATH TO BE CONSTRUCTED.

THE FITNESS FOR PURPOSE OF THIS STANDARD DRAWING FOR A SPECIFIC PROJECT SHALL BE ASSESSED AND ACCEPTED BY A SUITABLY QUALIFIED REGISTERED PROFESSIONAL ENGINEER OF QUEENSLAND (RPEQ).



BRISBANE CITY COUNCIL STANDARD DRAWING

CONCRETE FOOTPATH
DECORATIVE SAWCUT
SHEET 1 of 4

PUBLISH DATE		Mar '21
SCALE		NOT TO SCALE
DRAWING NUMBER		BSD-5207
ORIGINAL SIZE	REVISION	
A3	D	